

iRecharge[™] for Laptop Computers



User Manual

 **iRecharge[™]**
by **Cellboost[™]**

1.	Introduction	4
2.	What's in the package?	4
3.	Safety Precautions	5
4.	Getting Started	6
5.	Device Use	8
6.	Charging iRecharge	11
7.	LED Indication	13
8.	Tips for getting the best from your iRecharge	14
9.	Customer Service	14
10.	Warranty	15
11.	Technical Specifications	17

iRecharge for Laptops

1. Introduction

Thank you for purchasing iRecharge for Laptops. Before using this product, please read this user manual to learn about the features and capabilities of iRecharge and how to get the best from it.

2. What's in the package?

This package contains the following:



Battery Pack



Output Cable



Output Power Tip Bundle



Input Charging Tip Bundle



User Manual



Quick Start &
Compatibility Guide

3. Safety Precautions

iRecharge contains lithium ion batteries and is designed to provide safe and convenient portable power. iRecharge must be used in accordance with the instructions contained in this manual. Before use, please read and understand the entire contents of this user manual.



Misuse or abuse of iRecharge, or failure to properly follow the instructions in this manual may result in personal injury or fire

- Use only with the laptop models listed on the compatibility guide. If your laptop model is not listed on the compatibility guide, please visit www.Cellboost.com for more compatibility information.
- Use the power tip specified on the compatibility guide.
- Do not disassemble, puncture, throw, drop, bend or modify the iRecharge.
- Do not short-circuit.
- Avoid placing the iRecharge in direct sunlight, next to sources of heat, such as in a car where extreme temperatures may result.
- Avoid static electricity, strong magnetic fields and radiation.
- Do not submerge or expose the iRecharge to water or any other liquid.
- Do not allow children to play with the iRecharge.
- Operating only between 0 and 40°C, 5-95% RH, non-condensing.
- Storage only between 0 and 60°C, 5-95% RH, non-condensing.
- Recycle according to local recycling regulations.

4. Getting Started

Product Setup

Before using iRecharge, you must choose an input and output tip compatible with your laptop.

① Choosing an Input Charging Tip

This input tip will allow you to charge iRecharge using your laptop's AC adapter

- ▶ Refer to the compatibility guide and choose the correct input charging tip for your laptop. If the correct tip for your computer is tip number 5 for HP/Compaq, it is already installed into iRecharge. Please turn to the next page.
- ▶ Remove the input tip number 5 that ships in the housing by pulling on it firmly.
- ▶ Insert the correct input tip for your computer by inserting it into the opening in iRecharge and pressing firmly to lock in place. Please check that you have the orientation correct - it will only insert one way.

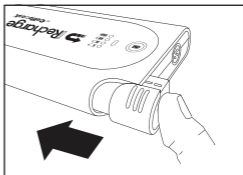
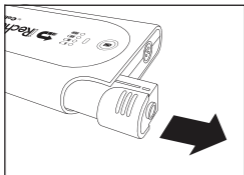

② Choosing an Output Power Tip

This power tip will allow you to connect the iRecharge battery to your laptop's AC adapter input.



- ▶ Refer to power tip compatibility guide and select correct power tip for your laptop computer.
- ▶ Connect the selected power tip to the output cable.

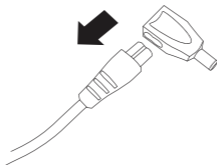

WARNING: The use of the incorrect power tip may damage your laptop.

- ▶ Connect the output cable to iRecharge (flat side up).

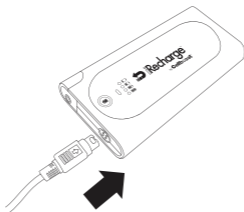

NOTE: Disconnect the output cable from the iRecharge battery unit when not in use to reduce battery discharge rate.

iRecharge for Laptops

Charging for the first time

iRecharge must be fully charged once before using for the first time. iRecharge is designed to be charged with your laptop's AC adapter.

Please refer to Section 6 "Charging iRecharge" for charging instructions.

5. Device Use

iRecharge provides power to your laptop in similar manner to your laptop's AC adapter. iRecharge provides power for both laptop operation and charging of the laptop's internal battery.

Before Use

To set up iRecharge input and output tips to work with your laptop, please refer to Section 4 "Getting Started".

To check the capacity remaining in iRecharge's batteries:

- ▶ Press the "Check" button located above the 4 LED fuel gauge.

Refer to the Section 7 "LED Indication" for details on reading the LED fuel gauge. If iRecharge has only a little remaining capacity, please charge before continuing.

To begin using iRecharge

- ▶ Connect iRecharge output cable into your laptop's charging port.

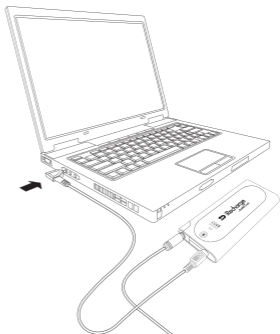
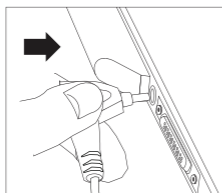

iRecharge will provide power to your laptop and your laptop will indicate that it is connected to AC power. Please refer to your laptop's user manual to identify its AC power connection indicator. In Windows XP you may see an icon similar to this:



WARNING: iRecharge is not recommended for use with laptops requiring more than 75W of power. If you use iRecharge with laptops requiring more than 75W, the performance of iRecharge may be limited. You can determine the power rating by reading the "OUTPUT" rating on the back of your laptop's AC adapter and multiplying the voltage (V) and current (A) together. If the rating is greater than 75W you should consider not using iRecharge with this laptop.

iRecharge for Laptops

IMPORTANT: To achieve the best performance from iRecharge you should **FULLY CHARGE** your laptop's internal battery **BEFORE** connecting iRecharge.

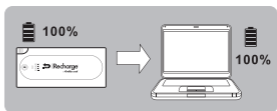

If the laptop's internal battery is not fully charged when iRecharge is connected, iRecharge will provide power to simultaneously run the laptop and charge the internal battery. This is an inefficient way to use iRecharge and will result in less operating time. Following the guidelines above will help you get the best performance from iRecharge.

NOTE: iRecharge may get warm during operation. This is normal. If iRecharge becomes abnormally hot, disconnect the output cable from the laptop and allow the unit to cool. If iRecharge is exposed to any source of heat that causes it to reach greater than 60°C it may not operate until the unit cools. If operation still does not resume following cooling down, power iRecharge for one minute from the AC adapter to reset.

NOTE: Using iRecharge with a laptop with a defective internal battery may reduce operating time.

During Use

To check remaining capacity

- ▶ Press the "Check" button above the 4 LED fuel gauge.

Refer to Section 7 "LED indication" for details on reading the LED fuel gauge.

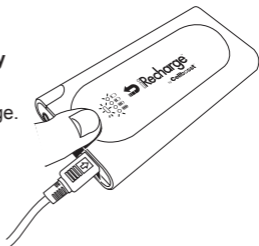

When iRecharge is exhausted

When the batteries in iRecharge are depleted, iRecharge will shut down and your laptop will revert to its internal battery. In Windows XP you may see indication similar to the following:



To use iRecharge again, follow the instructions for charging in the next section.

6. Charging iRecharge

iRecharge is designed to charge using your laptop computer's AC adapter. To set up iRecharge for charging, please refer to Section 4 "Getting Started".

To charge iRecharge for laptops

- ▶ Connect your laptop AC adapter to a wall outlet
- ▶ Connect the AC adapter output cable to the input charging tip of iRecharge

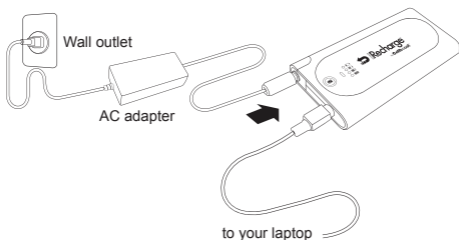

iRecharge for Laptops

- ▶ Normal charging is indicated by a RED charging status LED which will light a few seconds after a charging power source is connected.
- ▶ Allow iRecharge to charge fully – usually 3-8 hours. Your iRecharge is fully charged when the charging LED changes from RED (charging) to GREEN (fully charged)

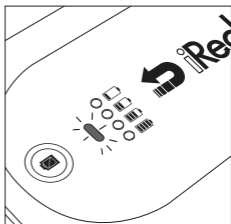

IMPORTANT NOTE: For fastest charging time, please power off your laptop or switch it to standby or hibernate mode. You may leave your laptop operating while you charge iRecharge, however this will extend the charging time. In some cases, especially with larger laptops, iRecharge may take a very long time to charge if used in this way. If you see this behavior please put your laptop into standby mode, hibernate mode, or power it off for 3-8 hours.





WARNING: Never mix input and output tips for different laptops on the same iRecharge unit. Never connect your laptop through iRecharge to an AC adapter that is not designed for it.

NOTE: iRecharge is designed to charge for up to 12 hours. If full charge is not reached within a 12 hour period, the charging circuit will shut down for safety reasons and the unit will indicate fully charged even if charging is not complete. To restart charging, disconnect and reconnect the charging power supply.

7. LED Indication





The charging status LED has two states as below:

 <i>Red</i>	Charging
 <i>Green</i>	Fully charged / Time out (see note on P12)

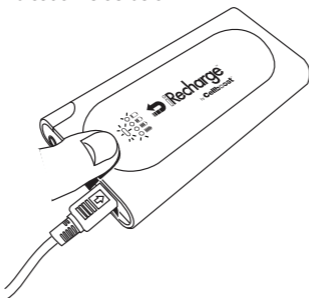
To check the capacity remaining in iRecharge:

- ▶ Press the check button located above the 4 LED fuel gauge. Indication is as below:



	<i>1 Green</i>	Battery Warning (Unable to provide power. Charge the battery)
	<i>2 Green</i>	Battery Low
	<i>3 Green</i>	Battery Medium
	<i>4 Green</i>	Battery High

8. Tips for getting the best from your iRecharge

- Fully charge your laptop's internal battery before connecting iRecharge. Don't wait until the laptop battery is nearly exhausted to connect iRecharge.
- Charge iRecharge while laptop is in "OFF", "STANDBY" or "HIBERNATE" mode.
- When you are not using iRecharge, disconnect the output cable from the battery unit to minimize self-discharge.
- Set your laptop's LCD to the minimum brightness you are comfortable with to help save power
- Enable the power saving features of your laptop computer such as hard disk and screen shutdown timers.
- Charge iRecharge at least once every 6 months when not in use.
- For long periods of storage, charge the battery above 80% prior to storage and store in a cool dry place with the output cable disconnected
- Operate only between 0 and 40°C, 5-95% RH, non-condensing and store between 0 and 60°C, 5-95% RH, non-condensing

9. Customer Service

If you encounter a problem with the iRecharge for Laptop Computers, please contact Compact Power Systems (toll-free from within the US & Canada) at (800) 833-1070, e-mail to customerservice@cpsyst.com or write to:

Compact Power Systems customer service

7801 Hayvenhurst Avenue
Van Nuys, California 91406
USA

10. Warranty

iRecharge Rapid Replacement One Year Warranty Service

Compact Power Systems' warranty obligations for iRecharge are limited to the terms set forth below:

Compact Power Systems, LLC. ("CPS") warrants the iRecharge product against defects in materials and workmanship for a period of one year from the date of original purchase ("Warranty Period"). If a defect arises and a valid claim is received by CPS within the Warranty Period, at its option, CPS will (1) repair the product at no charge, using new or refurbished replacement parts, (2) exchange the product with a product that is new or which has been manufactured from new or serviceable used parts and is at least functionally equivalent to the original product, or (3) refund the purchase price of the product. If a defect arises and a valid claim is received by CPS after the Warranty Period, a shipping and handling charge will apply to any repair or exchange of the product undertaken by CPS. When a product or part is exchanged, any replacement item becomes your property and the replaced item becomes CPS's property. When a refund is given, your product becomes CPS's property.

EXCLUSIONS AND LIMITATIONS

CPS is not liable for any damage or your portable device or loss of any programs, data, or other information stored on any media contained within your device or any non-CPS product or part not covered by this warranty. Recovery or reinstallation of programs, data or other information is not covered under this Limited Warranty. This warranty does not apply: (a) to damage caused by accident, abuse, misuse, misapplication, or non-CPS products; (b) to damage caused by service performed by anyone other than CPS; (c) to a product or a part that has been modified without the written permission of CPS; or (d) if any CPS serial number has been removed or defaced.

iRecharge for Laptops

TO THE MAXIMUM EXTENT PERMITTED BY LAW, THIS WARRANTY AND THE REMEDIES SET FORTH ABOVE ARE EXCLUSIVE AND IN LIEU OF ALL OTHER WARRANTIES, REMEDIES AND CONDITIONS, WHETHER ORAL OR WRITTEN, EXPRESS OR IMPLIED. CPS SPECIFICALLY DISCLAIMS ANY AND ALL IMPLIED WARRANTIES, INCLUDING, WITHOUT LIMITATION, WARRANTIES OF MERCHANTABILITY AND FITNESS FOR A PARTICULAR PURPOSE. IF CPS CANNOT LAWFULLY DISCLAIM OR EXCLUDE IMPLIED WARRANTIES UNDER APPLICABLE LAW, THEN TO THE EXTENT POSSIBLE ANY CLAIMS UNDER SUCH IMPLIED WARRANTIES SHALL EXPIRE ON EXPIRATION OF THE WARRANTY PERIOD. No CPS reseller, agent, or employee is authorized to make any modification, extension, or addition to this warranty.

TO THE MAXIMUM EXTENT PERMITTED BY LAW, CPS IS NOT RESPONSIBLE FOR DIRECT, SPECIAL, INCIDENTAL OR CONSEQUENTIAL DAMAGES RESULTING FROM ANY BREACH OF WARRANTY OR CONDITION, OR UNDER ANY OTHER LEGAL THEORY, INCLUDING BUT NOT LIMITED TO, LOST PROFITS, DOWNTIME, GOODWILL, DAMAGE TO OR REPROGRAMMING OR REPRODUCING, ANY PROGRAM OR DATA STORED IN OR USED WITH CPS PRODUCTS.

How to get Rapid Replacement warranty service:

1. For information on obtaining Rapid Replacement warranty service, e-mail Compact Power Systems customer service at customerservice@cpsyst.com or call Compact Power Systems. Compact Power Systems' Rapid Replacement Customer Support telephone number is (toll free in the U.S & Canada) (800) 833-1070.

2. To obtain Rapid Replacement warranty service, you will be required to provide:

- The original dated sales slip
- Your name
- Your address and e-mail
- The serial number of the product
- The product name, where purchased and a description of the problem.

3. Take or ship the product in the original or a properly padded, protective replacement container to CPS at the below address:

Compact Power Systems Rapid Replacement Warranty Service

7801 Hayvenhurst Avenue
Van Nuys, California 91406
USA

11. Technical Specifications

Maximum Capacity	52Wh
Output Voltage	15V~24V
Output Power	Max 72W
Operating Time	Up to 4 hours, depending on laptop and, settings and usage
Charging Time	3~8hours
Dimensions	165 x 80 x 24 mm
Weight	430g

iRecharge for Laptops

NOTE:

NOTE:

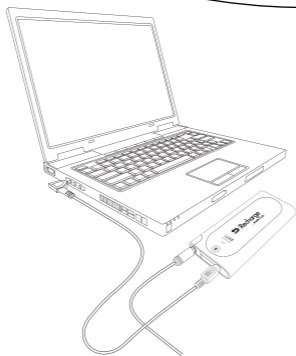

 **iRecharge**[™]
by **Cellboost**[™]

iRecharge for Laptop Computers
