

# MTGBAVX10 HD / MTG13UHD

## 10.1" / 13.3" Overhead LCD Monitor With Built-In DVD Player Installation Guide

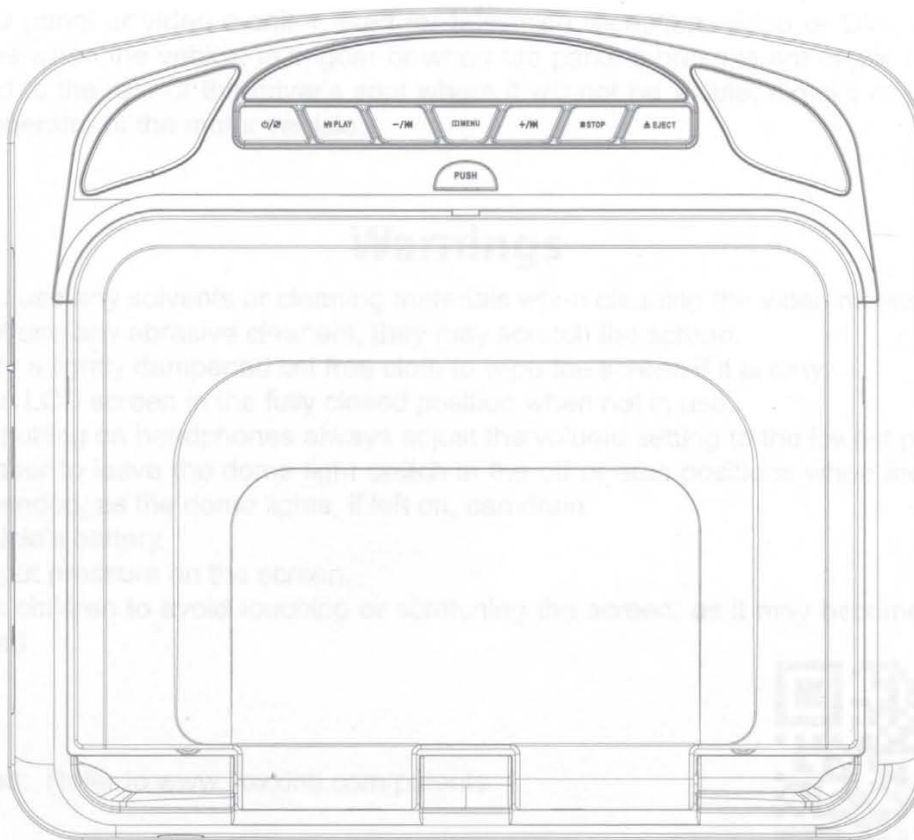

## Safety Precaution

For safety reasons, when changing video media, it is recommended that the vehicle is not in motion, and that you do not allow children to unfasten seat belts to change video media or make any adjustments to the system. System adjustments can be accomplished using the remote control, while seat belts remain fastened. Enjoy your entertainment system but remember the safety of all passengers remains the number one priority.

When connecting power and ground to a mobile video installation, ensure that the ACC wire is fused at the point where it is connected to the vehicle ACC wiring. Failure to do so can result in damage to the vehicle. A short circuit develops between the vehicle connector and the mobile video product.

An LCD panel and/or video monitor may be installed in a motor vehicle and visible to the driver if the LCD panel or video monitor is used for vehicle information system control, rest or side reservation or navigation. If the LCD panel or video monitor is used for television reception, video or DVD play, the LCD panel or video monitor must be installed so that these features will only function when the vehicle is in "park" or when the vehicle's parking brake is applied.

An LCD panel or video monitor used for television reception, video or DVD play that operates when the vehicle is in gear or when the parking brake is not applied must be installed to the rear of the driver's seat where it will not be visible, directly or indirectly, to the operator of the motor vehicle.

## Warnings

- Do not use any solvents or cleaning materials when cleaning the video monitor.
- Do not use any abrasive cleaners, they may scratch the screen.
- Use only a lightly dampened lint free cloth to wipe the screen if it is dirty.
- Lock the LCD screen in the fully closed position when not in use.
- Before putting on headphones always adjust the volume setting to the lowest position.
- Remember to leave the dome light switch in the off or auto position when the vehicle is unattended, as the dome light, if left on, can drain the vehicle's battery.

Do not put pressure on the screen.  
Caution: Children to avoid touching or scratching the screen, as it may become dirty or damaged.



Patented. Refer to [www.voxixll.com/patents](http://www.voxixll.com/patents)

## Table Of Contents

Materials Include In This Package.....	6
Installing The Unit In A Vehicle.....	8
Installing The Snap-On Shroud .....	9
Installing The Snap-On Screen Cover.....	10
Installing The Trim Ring.....	11
General Vehicle Installation Approach .....	12
Vehicle Preparation.....	13
Connecting The Dome Lights.....	14
Installing The Mounting Bracket.....	16
Installing The Unit Video System- Wiring Diagram .....	17
Installing The Unit Video System- Mounting The Unit.....	19
Appendix A - Removing The Screen Back Cover.....	20
Appendix A - Removing The Trim Ring and Shroud .....	21
Appendix B - Installing The Optional Thick Trim Ring.....	22
Appendix C - Installing The Optional SmartStream Module (WM1) ..	23
Troubleshooting .....	24

## Materials Included In This Package

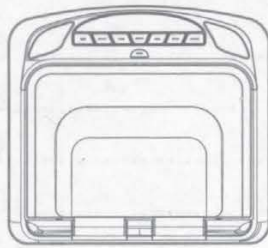

1

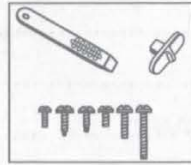

2



3

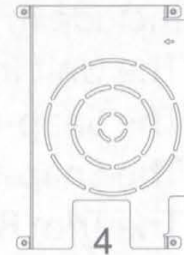

4

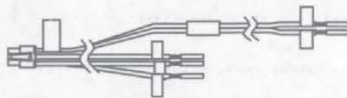

5

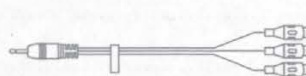

6

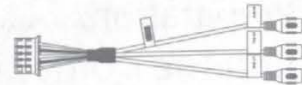

7

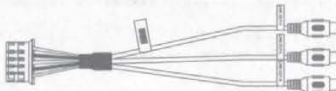

8

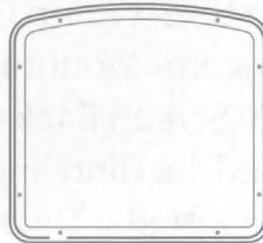

9

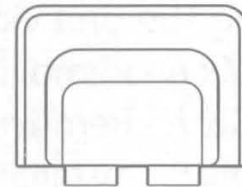

10



11

- |    |   |            |
|----|---|------------|
| 1. | 10.1" / 13.3" TFT LCD Overhead Monitor with DVD Player      | - (1 pc)   |
| 2. | Hardware Package (P/N 540-017)                              | - (1 pkg)  |
|    | M3 x 5mm Phillips Screws                                    | - (12 pcs) |
|    | #8 x 3/8" Self Drilling Screws                              | - (4 pcs)  |
|    | <b>(*NOTE: For Installation of WM1x4pcs)</b>                |            |
|    | M5 x 10mm Phillips Screws                                   | - (4 pcs)  |
|    | M5 x 20mm Phillips Screws                                   | - (4 pcs)  |
|    | M5 x 40mm Phillips Screws                                   | - (4 pcs)  |
|    | Pry Tool and Slide Knob for Dome Light Switch (P/N 540-018) | - (1 pc)   |

**CAUTION:** The 10mm, 20mm and 40mm screws in the hardware kit are provided to facilitate installation. Use extreme caution when using these screws to avoid damage to vehicle roof or other components, wiring, etc.

## Materials Included In This Package

- |  |               |
|--|---------------|
| 3. Remote Control w/ Battery (P/N 500-003)                       | - (1 pc)      |
| 4. For 10.1"-Mounting Bracket (P/N 201-413)                      | - (1 pc)      |
| 13.3"-Mounting Bracket (P/N 201-414)                             | - (1 pc)      |
| 5. 6 Pin Power/Dome Light Harness (P/N 112-4270)                 | - (1 pc)      |
| 6. AUX Pigtail (P/N 112B3227)                                    | - (1 pc)      |
| 7. 5 Pin AV input Harness (P/N 112-4259)                         | - (1 pc)      |
| 8. 5 Pin AV output Harness (P/N 112-4260)                        | - (1 pc)      |
| 9. For 10.1"- Trim Ring - Shale (P/N 306-239)                    | - (1 pc)      |
| - Pewter (P/N 306-240)   | - (1 pc)      |
| - Black (P/N 306-241)  | - (1 pc)      |
| For 13.3"- Trim Ring - Shale (P/N 306-250)                       | - (1 pc)      |
| - Pewter (P/N 306-251)   | - (1 pc)      |
| - Black (P/N 306-252)  | - (1 pc)      |
| 10. For 10.1"- Snap On Cover (Screen Back) - Shale (P/N 306-242) | - (1 pc)      |
| - Pewter (P/N 306-243)   | - (1 pc)      |
| - Black (P/N 306-244)  | - (1 pc)      |
| For 13.3"- Snap On Cover (Screen Back) - Shale (P/N 306-253)     | - (1 pc)      |
| - Pewter (P/N 306-254)   | - (1 pc)      |
| - Black (P/N 306-255)  | - (1 pc)      |
| 11. For 10.1"- Snap On Cover (Shroud) - Shale (P/N 306-245)      | - (1 pc)      |
| - Pewter (P/N 306-246)   | - (1 pc)      |
| - Black (P/N 306-247)  | - (1 pc)      |
| For 13.3"- Snap On Cover (Shroud) - Shale (P/N 306-256)          | - (1 pc)      |
| - Pewter (P/N 306-257)   | - (1 pc)      |
| - Black (P/N 306-258)  | - (1 pc)      |
| 12. Installation Guide & Owner's Manual (Not Shown)              | - (1 of each) |

Optional Accessories : 1. SmartStream Module (P/N: WM1))

2. Wireless Headphones w/ Batteries

3. HDMI/USB Extension Cable with Connector Port (P/N: HDH12)

## Installing the Unit In A Vehicle

### Tools Required

1. #2 Phillips Screwdriver
2. #1 Phillips Screwdriver
3. Utility or Razor Knife
4. Wire Strippers
5. Upholstery hook tool (for removal of panels as necessary)
6. Electrical Tape
7. Masking Tape
8. Multimeter to verify 12 volt DC and continuity (Do not use a test light or logic probe)
9. Marker pen – to mark headliner, to mark trim ring if used
10. Scribe (to mark trim ring if used)
11. Miscellaneous:
  - Electrical Connectors (to connect to vehicle power source, requirements will vary from vehicle to vehicle)
  - DVD Disc, USB Content and HDMI device (to verify system operation after installation)

### Preparation

Place the unit on a soft surface to avoid damaging the plastic.

### Installing the Snap On Covers

*The Unit is supplied with black, shale and pewter plastics to allow for a custom installation. Choose the desired color and install as follows.*

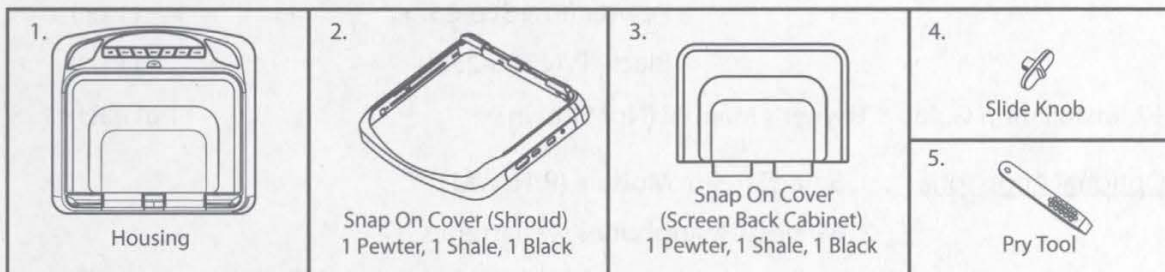

## Installing the snap-on shroud

### Installing the Shroud

**\*NOTE:** Work on a soft surface to avoid damaging the plastic.

1. Remove the double sided tape backing from the two strips on the center section of the shroud.
2. Hook the shroud over the dome light and align the shroud tabs (1) with the eight openings around the rim of DVD player (2).
3. Slide the shroud down until the shroud completely covers the DVD player and that all eight tabs snap into all eight openings around the DVD player (1) & (2).
4. Apply pressure to the center section of the shroud in the area of the double sided tape to ensure that the tape adheres.
5. Locate the Slide Knob (3) in the hardware package and press it onto the dome light switch (4) on the side of the DVD player.

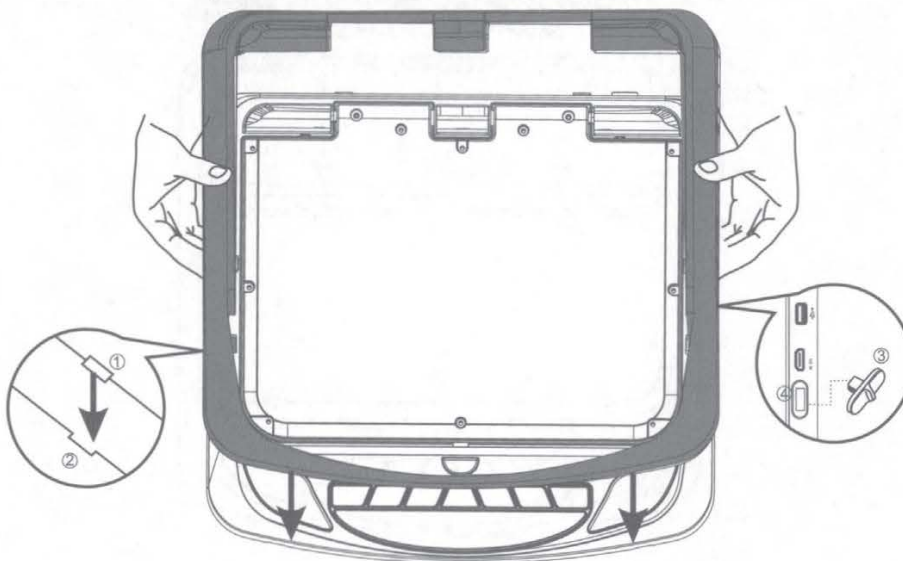

## Installing the Snap-On Screen Cover

### Installing the Screen Cover

1. Open the LCD screen.
2. Hook the two tabs "A" (as shown) on the bottom edge of the screen.
3. Carefully snap the opposite side over the hinge.

**NOTE:** *If the wrong color Shroud and Screen Cover is installed, refer to Appendix A of this manual for instructions to change the Shroud and Screen Cover color.*

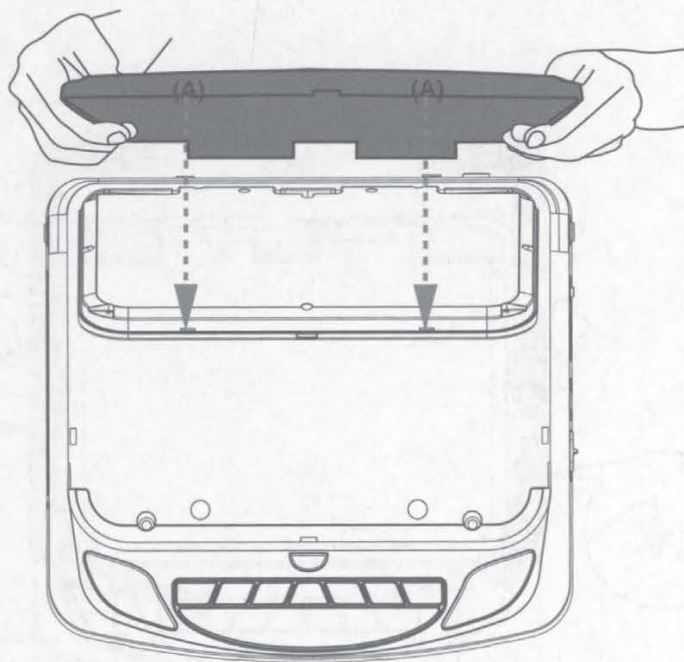

## Installing the Trim Ring

The trim ring is attached to the video monitor using the perimeter screw bosses. It is important that the screws used in this installation are not over tightened, and that the video monitor and trim ring are mounted in such a way that the assembly does not distort (or bend) when the mounting screws are tightened.

There are two Trim Ring options for mounting the Unit, one is to use the supplied Trim Ring for all vehicles with flat headliner mounting areas (no contour) or a thick Trim Ring (not supplied) that can be cut to fit the contour of a headliner that is not flat (see Appendix B of this manual).

**NOTE:** *The trim rings supplied with this unit are not designed to be trimmed.*

### Installing the Trim Ring

1. Turn the DVD Player over on a surface with protective covering to prevent scratches.
2. Place the trim ring onto the DVD Player. Align the pins on the trim ring with the holes in the metal chassis plate.



3. Locate the eight (8) M3 x 5mm screws in the hardware kit.
4. Using a screwdriver, install the eight (8) M3 x 5mm screws into the locations marked "A" shown in the figure below.

**NOTE:** *Use caution tightening screws as the threads may strip in the overhead assembly.*

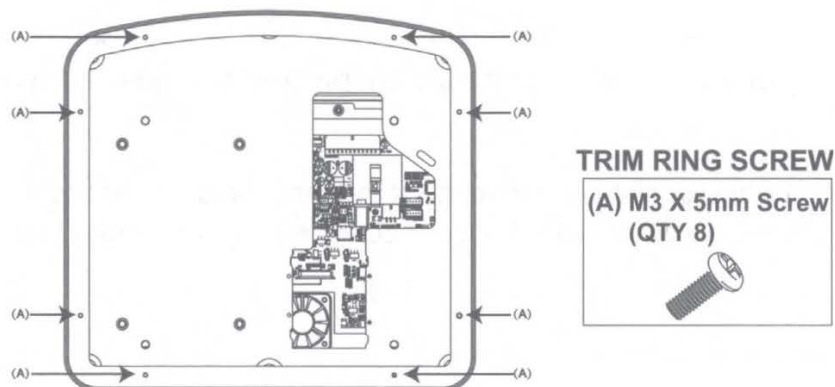

## General Vehicle Installation Approach

1. Decide upon system configuration and configuration and peripheral options that will be installed (ie...External Video Gaming System).
2. Review all manuals to become familiar with electrical requirements and connections.
3. Decide upon mounting locations of all components and method of mounting.
4. Prep the vehicle by removing any interior trim necessary to gain access to vehicle's wiring as well as all areas where interconnecting wire harnesses will need to be located. If any access holes need to be cut into the vehicle (headliner, other trim components etc.), this should be done now as well.
5. Route the wiring harnesses throughout the vehicle as necessary including the wiring for any additional peripheral devices being added to this system. ( as well as the wiring instructions for the individual components and accessory options being installed). Be sure that all wiring is protected from sharp edges and is routed in such a manner that wiring is not pinched when all components and interior trim are fully installed. Be sure to leave enough slack in the wiring at each component to allow working room. Avoid routing wiring near or over airbag wiring or airbags.
6. Remove all A/V system components from their packaging and place them loosely in the vehicle at their respective locations.
7. Connect all components together (electrically) and verify proper operation of all system functions.  

Note: Testing of the system is best performed BEFORE the Overhead Monitor is mounted to the supplied bracket and any optional accessories are permanently mounted.
8. After verifying proper operation of the system proceed to mount each component.
9. When all components are mounted recheck the function of the entire system again to ensure that no wiring was pinched or connected improperly during final installation.

## Vehicle Preparation

1. Locate an accessory +12v power source with a good ground. These wires can be found at the ignition switch or fuse-box.

### Power Source

- +12v when the key is in the ACC and run positions.
- 0v when the key is OFF.

**NOTE:** *Always fuse the ACC +12V at the source where it is connected to the vehicle.*

2. Some vehicles come equipped with a factory option that places the vehicle in an “Environmental Friendly” mode that shuts down the engine when the vehicle is not in motion. This may cause this Mobile Video system to shut down depending on the operating voltage of the vehicle when in this mode. Please note that this system must be connected to a stable ACC +12V power feed. Any voltage supplied to this unit less than +12V could result in performance issues or system shutdown. This is not a defect so take precaution if in fact the vehicle for which this Mobile Video system is installed has this factory option.
3. The mounting method and location will vary from vehicle to vehicle, the only focus of this manual is to provide proper installation guidance for this system.
4. Generally, the best location for the video monitor is where the vehicle’s factory dome light is installed. The monitor should be located in such a manner that it can be comfortably viewed by rear seat passengers.

**NOTE:** *Never install the monitor in a place within the driver’s view. This is not only dangerous, but it is also illegal in many states.*

5. Once the mounting location of the monitor has been determined, additional preparation work may be necessary, depending on the vehicle structure and installation method. Some of the steps that may be required are:
  - a. Removal of the vehicle’s dome light.
  - b. Cutting an opening in the headliner to install the mounting bracket.
  - c. If the optional Thick Trim Ring will be used, it may have to be trimmed to fit the contour of the vehicle’s headliner. Refer to Appendix B Installing the Optional Thick Trim Ring.

## Connecting the Dome Lights

The dome lights in the video monitor require three connections to the vehicle's wiring. There are two common types of dome light circuits used, positive switched systems or negative switched systems. Positive switched systems supply voltage to the interior lights to turn ON; negative switched systems apply ground to illuminate the bulbs.

To determine which system you have to locate the wires at the dome light:

- On a positive switched system, with all the doors closed and the lights out, both wires at the dome light will rest at ground. When the light is activated, one of these wires will switch to +12 VDC. This is the vehicle's switching wire Lamp auto.
- On a negative switched system, with all the doors closed and the lights out, both wires at the dome light will rest at +12 VDC. When the light is activated, one of these wires will switch to ground. This is the vehicle's switching wire Lamp auto.

For positive switched systems, connect the Purple / Brown (Lamp Auto) wire to the vehicle's switched wire. Then connect the Red / Black (Lamp ON) wire to a fused constant 12 volt source and the Black / Red (Lamp Common) wire to a good ground. Positive switched systems are commonly found on Ford vehicles.

For negative switched systems, connect the Purple / Brown (Lamp Auto) wire to the vehicle's switched wire. Then connect the Red / Black (Lamp On) wire to a good ground and the Black / Red (Lamp Common) wire to a fused constant 12 volt source. Negative switched systems are commonly found on General Motors and import vehicles.

**NOTE:** *Some vehicles which incorporate transistorized control of the dome light circuit, may require that the Purple / brown (Lamp Auto) wire be connected to the door pin switch wire, as the additional current draw of the monitor's lights may not be supported by the output of the vehicle's body control computer.*

**After wiring the dome lights make sure the dome lights operate properly with doors opening and closing and that they are not always on. Do not leave the dome lamp switch on the DVD overhead in ON position as this will drain the battery over time.**

## Connecting the Dome Lights

### Positive Switched Dome Lighting

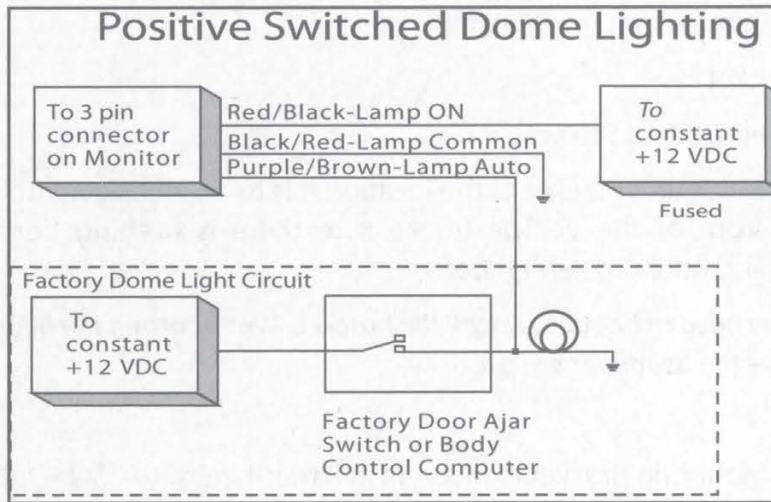

### Negative Switched Dome Lighting

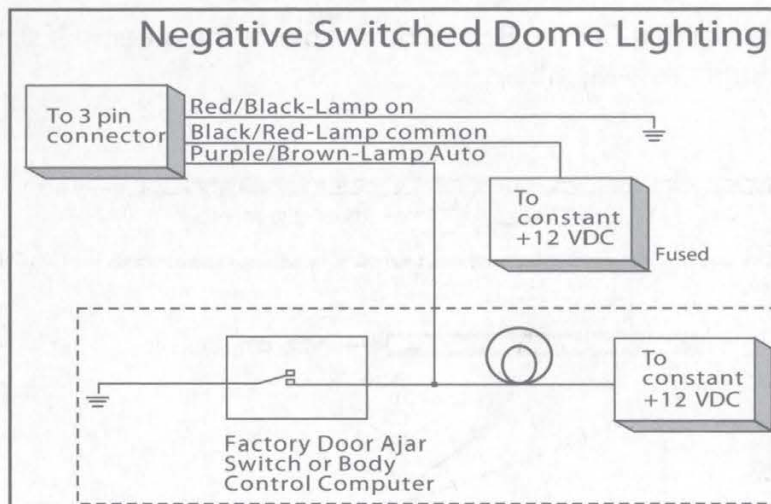

## Installing the Mounting Bracket

### Installing the Mounting Bracket

1. Once all the pre-wiring is complete, locate:
  - Mounting Bracket
  - (4) #8 x 3/8" Self-Drilling Screws
2. Carefully align the Mounting Bracket in the location it is to be installed with direction arrow facing the front of the vehicle (make sure there is nothing between the Mounting Bracket and Roof Cross-Member).

**NOTE:** The headliner may need to be cut to install the bracket. When cutting the headliner, make sure no wires above the headliner are cut.

3. While holding the Mounting Bracket in place, install the 4- #8 x 3/8" Self-Drilling Screws.

**CAUTION:** Be sure that the Self-Drilling Screws do not pierce the outer roof skin when fully fastened to the Roof Cross-Member.

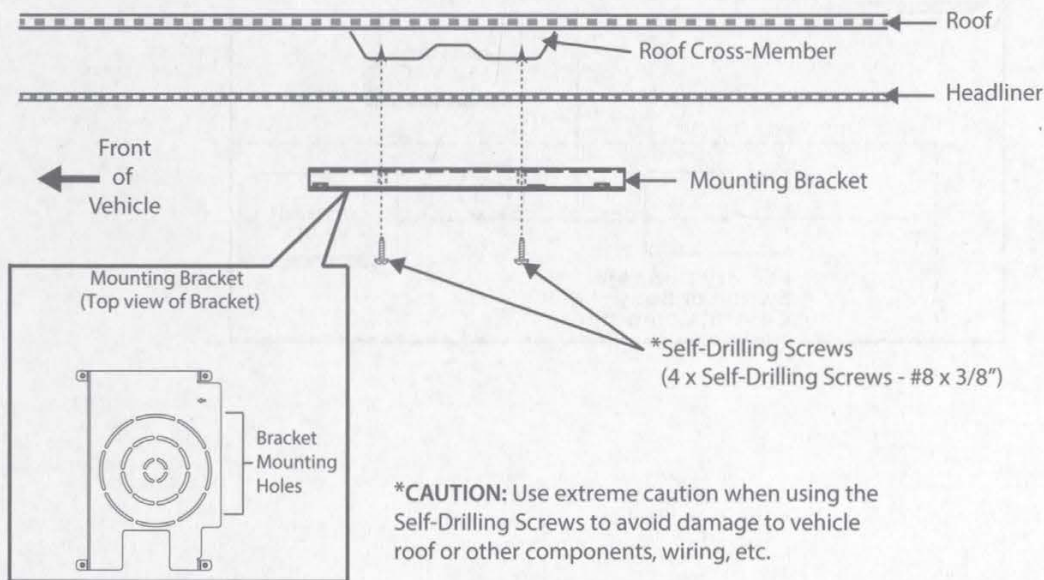

**WARNING:** Any use of a mounting substrate other than the supplied bracket may result in performance issues. The supplied bracket was designed to ensure this Mobile Video System is properly installed without adding any strain or stress to the system which could result in unit operation problems.

## Installing the Unit Video System-Wiring Diagram

1. Connect the 6 pin harness to the unit and make the connections to the vehicle.
2. Connect the red and black power wires of the Power Harness to vehicle's electrical system by connecting into an accessory hot line and a good ground. Soldering all power connection is the suggested technique that should be used to ensure a problem free connection.
3. If connecting to an external source, connect the 5 Pin AV Input Harness (112-4259 Blue Connector) to provide AV signal input to the system.
4. If connecting to an external source, connect the if used 5 Pin AV Output Harness (112-4260 White Connector) to provide AV signal output from the system.
5. Verify all system functions before final mounting of the finished assembly.

### Input Source Options

- Internal User Accessible:
  - DVD/USB/HD/AUX AV Inputs
- External Hidden:
  - AV Input via supplied harness 112-4259
  - AV Output via supplied harness 112-4260
  - Wireless Content Streaming via optional SmartStream module (WM1)
  - Remote HD/USB connection via optional cable (HDH12)

**NOTE: The antenna has been designed for optimal performance.**

***When installing the unit, position the antenna for best reception.***

# Installing the Unit Video System-Wiring Diagram

## Wiring Diagram

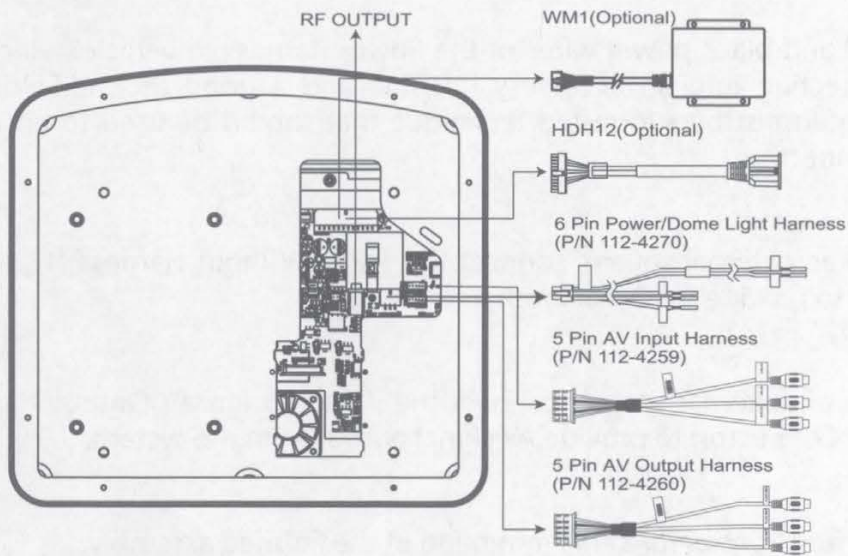

**NOTE: The Hidden 24 Pin connector only allows connection of either optional SmartStream Module (WM1) or HD/USB Extension harness (HDH12).**

## Installing the Unit Video System-Mounting the Unit

### Installing the System

1. Make all electrical connections.
2. Attach the Unit to the mounting bracket using four M5 screws.

**CAUTION:** The M5 screws are supplied in three different lengths (10mm, 20mm and 40mm) to facilitate proper installation. Use extreme caution when using these screws to avoid damage to vehicle roof or other components, wiring, etc.

**CAUTION:** Do not trap any bulk wiring or other accessories such as filters between the supplied bracket and the unit. Any such items can block air flow in addition to placing pressure on the top of the unit which could lead to performance issues.

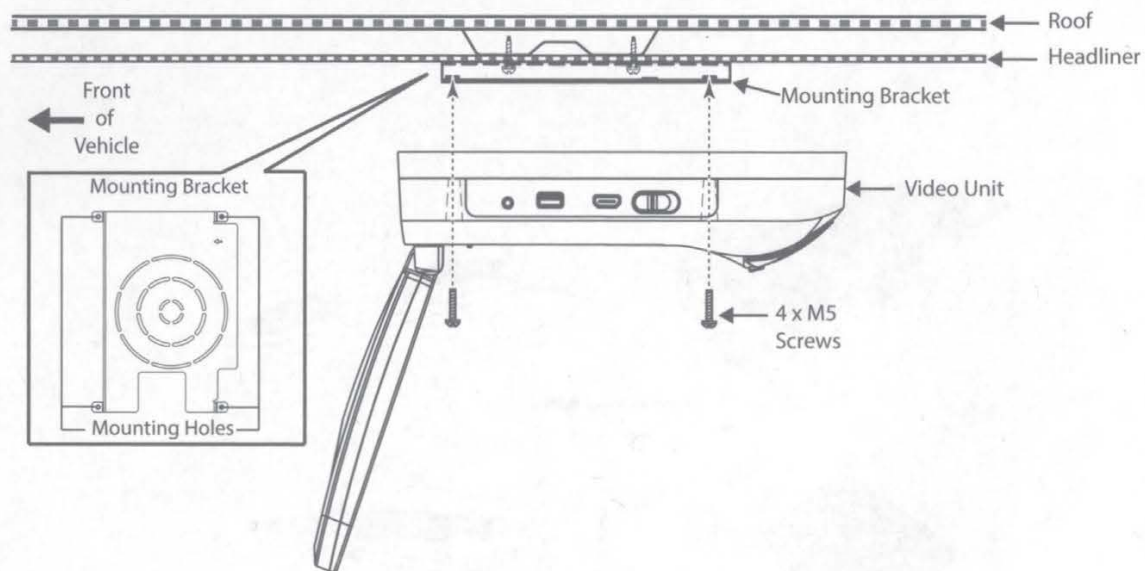

## Appendix A - Removing the Screen Back Cover

This section is intended for situations where the color of the Shroud, Screen Cover and Trim Ring need to be changed after the unit is setup for installation.

**NOTE: Work on a soft surface to avoid damaging the plastic.**

### Removing the Screen Back Cover

1. Starting from the back of the unit, carefully insert the supplied pry tool between the Housing and Screen Back Cover.
2. Press the pry tool to release the Screen Back Cover.
3. While lifting the Screen Back Cover, slide the pry tool around to the attaching areas and press the pry tool to release the Screen Back Cover.
4. Remove the Screen Back Cover and discard.

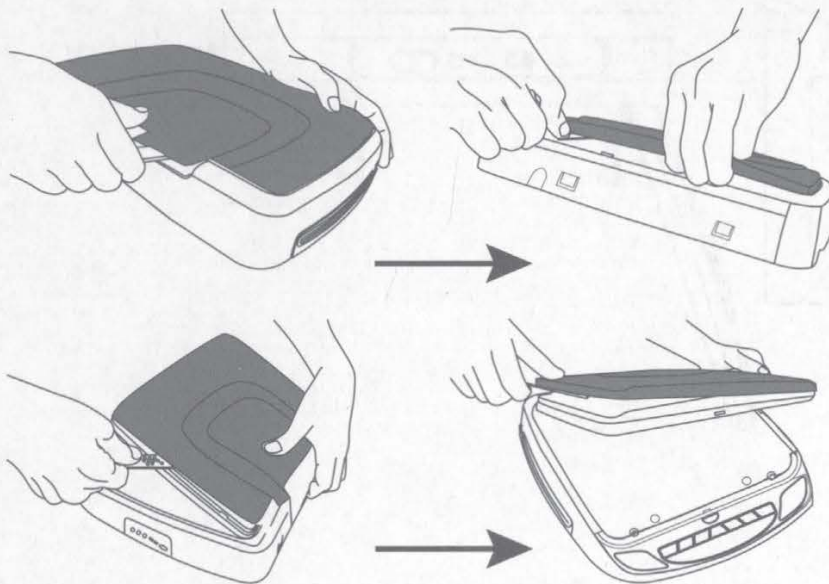

## Appendix A - Removing the Trim Ring and Shroud

### Removing the Trim Ring

1. Remove the Trim Ring screws ((8) M3 x 5mm screws).

**NOTE:** Do not Discard Screws! These screws are used to attach the new Trim Ring.

2. Remove the Trim Ring and discard.

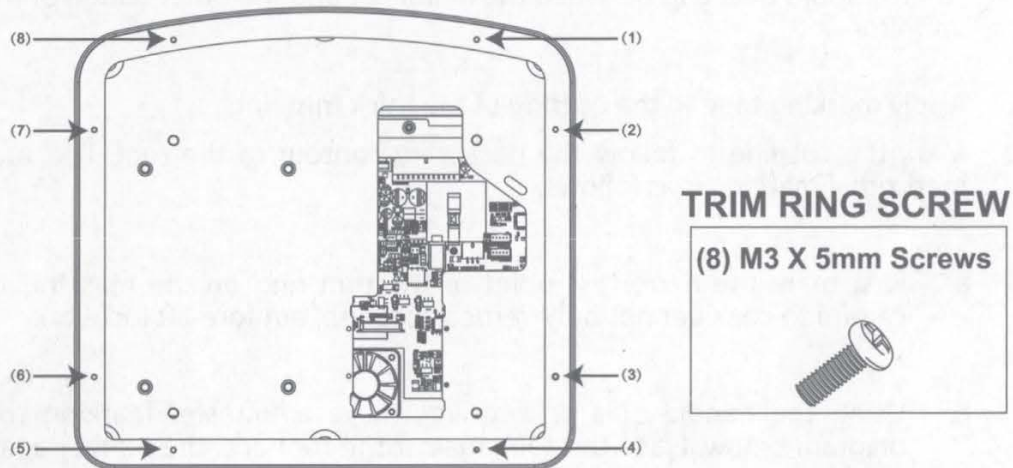

### Removing the Shroud

1. Using the supplied pry tool, remove the slide knob from the dome light switch located on the side of the DVD player.

**NOTE:** Do not Discard knob! The knob is reused.

2. Open the screen and insert the supplied pry tool between the Housing and Shroud and disengage the tape on the center section of the shroud.
3. Press the pry tool to disengage the attaching Shroud clips.
4. Continue disengaging the attaching areas around the unit removing the Shroud and discard.

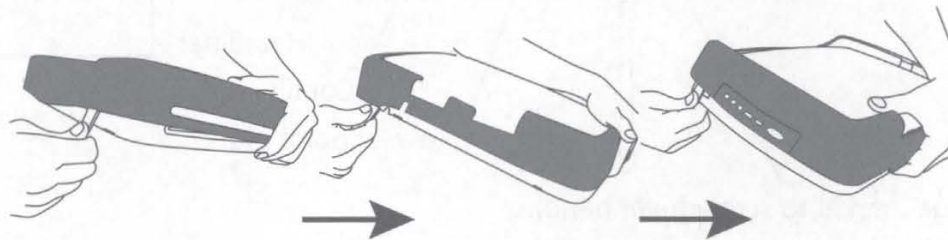

## Appendix B - Installing the Optional Thick Trim Ring

This section covers only special installation considerations for the optional thick trim ring installation. consideration for when an installation requires use of our Optional thick trim ring.

Important NOTES before installing the thick trim ring:

- There should be a gap between the headliner and the outer flange of the video monitor.
1. Apply masking tape to the outside of the thick trim ring.
  2. Mark the cut line to follow the necessary contour of the roof. The suggested method of marking is as follows:
    - a. First mark the narrowest point of the trim ring on the masking tape. Be careful to consider not only vertical location, but fore-aft location.
    - b. Using the handle of a screwdriver, make a "transfer marking tool". See diagram below. Place the tool against the roof and the marker against the masking tape on the trim ring. Trace the cut to be made around the entire perimeter of the trim ring.
  3. Cut the trim ring using a sharp utility knife or shears. Make the cut in several passes over the marked line, each time cutting a little deeper. It is not necessary to cut completely through the plastic, the cut only need be over 50% of the wall thickness of the plastic. By bending the cut back and forth several times, the plastic will break cleanly at the cut.
  4. Check the fit of the trimmed console and make any minor adjustments necessary.

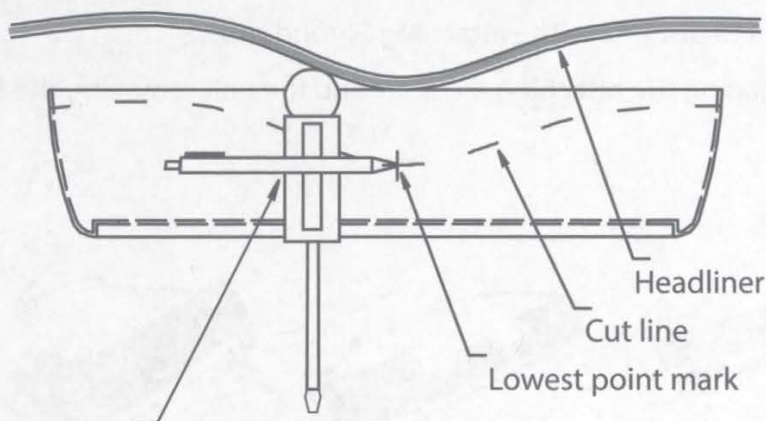

THICK TRIM RING PART NUMBERS	
Shale -	1187270PL
Pewter-	1187271PL
Black-	1187272PL

Tape marker to screwdriver handle.

Starting at your mark for the lowest point,

trace the contour of the roof around the perimeter of the trim ring.

## Appendix C - Installing the Optional SmartStream Module (WM1)

This section is intended as an installation guide to connect the WM1 Module to the Unit.

**NOTE:** *The WM1 Module is sold separately and is supplied with its own instruction manual.*

### Installing the WM1 Module

1. Turn the DVD Player over on a surface with protective covering to prevent scratches.
2. Begin looping the excess WM1 Module harness under the protective top plate towards the back of the DVD player as shown.
3. Place the WM1 Module onto the mounting standoffs.
4. Locate the four M3 x 5mm Screws in the Unit hardware kit.
5. Using a screwdriver, install the four screws into the four locations shown.

**NOTE:** *Use caution tightening screws as the threads may strip in the assembly.*

6. Insert the 8-pin connector of the WM1 Module harness into the location shown.

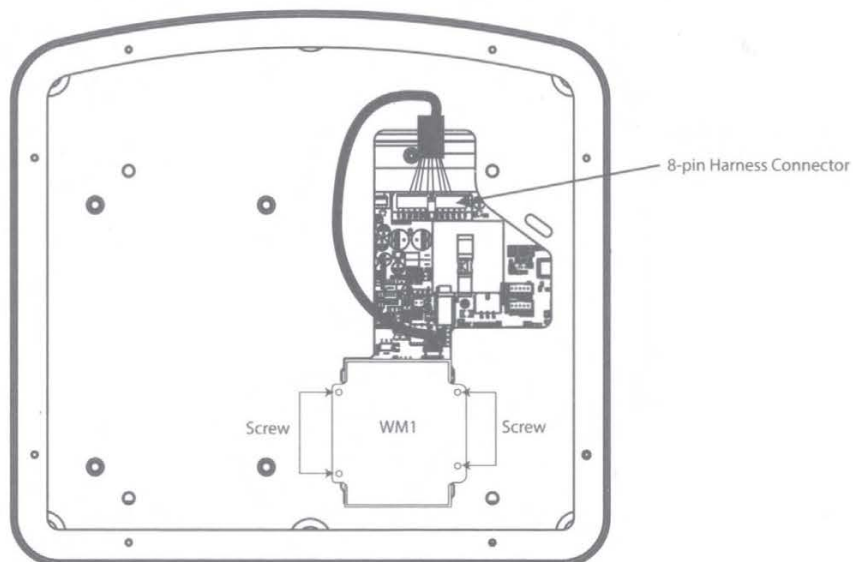

Back of Unit

## Troubleshooting

SYMPTOM:	REMEDY:
No power at video monitor	<ul style="list-style-type: none"> <li>• Verify +12 VDC on the Red wire at 6 Pin Power/Dome Light Harness behind the video monitor. Verify a ground connection with a continuity test from a known good ground to the black wire.</li> </ul>
Power but no video or sound	<ul style="list-style-type: none"> <li>• Verify that the Source is on and playing back compatible media content.</li> </ul>
Disc will not play or wrong region is displayed	<ul style="list-style-type: none"> <li>• Check to ensure the disc was put in with the correct side for playback (Label side up/shiny side down). <b>NOTE: The DVD system only plays digital video discs, audio CDs and MP3s.</b></li> <li>• Both the unit and the disc are coded by region. If the regional codes don't match, the disc can't be played. This DVD player is set to Region 1.</li> </ul>
IR Wireless Headphones do not work	<ul style="list-style-type: none"> <li>• Check if batteries are installed correctly.</li> <li>• Make sure that the headphone batteries are fresh.</li> <li>• Check if Power Button lights up when pressed. If Power Button does not light up when pressed, change batteries.</li> <li>• If using Dual Channel Wireless Headphones, make sure the correct channel is selected.</li> <li>• Make sure the IRT power is ON. Press the IRT ON/OFF button on the remote control and IRT ON or IRT OFF is displayed.</li> </ul>

## Troubleshooting

SYMPTOM:	REMEDY:
FM Transmitter does not work	<ul style="list-style-type: none"><li>• Check if radio is ON and in FM mode.</li><li>• Check that radio is tuned to the same frequency as the unit is set to.</li><li>• Select another FM channel.</li><li>• Reposition the Unit Wireless FM antenna for better reception.</li></ul> <p>Optional Module FMDIRB will allow the internal FM Transmitter to become a hardwired FM modulator. This option will provide the best FM connection to the vehicle radio.</p>
Remote Control does not work	<ul style="list-style-type: none"><li>• Check if the battery is installed correctly.</li><li>• Make sure that the remote control battery is fresh.</li><li>• The remote control is a dual function remote control, make sure M1/M2 is selected correctly.</li></ul>
HDMI source does not work with smartphone	<ul style="list-style-type: none"><li>• A special adapter is required to connect a smartphone to the HD input. Contact the smartphone service provider for ordering information on the appropriate adapter.</li></ul>

## Important Notices

Installation of overhead products requires careful planning and preparation. Be extremely careful when working on a vehicle with side curtain air bags. Do not route wires near any portion of the side curtain air bag assemblies. This includes any anchor points in A, B, C or D pillars of the vehicle. Routing wires in these areas or running wires by the side curtain air bags can prevent the side curtain air bag from fully deploying which can result in personal injury to vehicle occupants. If you have any questions regarding wire routing in a vehicle, please contact Audiovox Technical Support at 1-800-225-6074.

When connecting power and ground in a mobile video installation, ensure that the ACC wire is fused at the point where it is connected to the vehicle ACC wiring. Failure to do so can result in damage to the vehicle if a short circuit develops between the vehicle connection point and the mobile video product.

An LCD panel and/or video monitor may be installed in a motor vehicle and visible to the driver if the LCD panel or video monitor is used for vehicle information, system control, rear or side observation or navigation. If the LCD panel or video monitor is used for television reception, video or DVD play, the LCD panel or video monitor must be installed so that these features will only function when the vehicle is in "park" or when the vehicle's parking brake is applied.

An LCD panel or video monitor used for television reception, video or DVD play that operates when the vehicle is in gear or when the parking brake is not applied must be installed to the rear of the driver's seat where it will not be visible, directly or indirectly, to the operator of the motor vehicle.

## Warnings

- Do not use any solvents or cleaning materials when cleaning the video monitor.
- Do not use any abrasive cleaners, they may scratch the screen.

Use only a lightly dampened lint free cloth to wipe the screen if it is dirty.

Lock the LCD screen in the fully closed position when not in use.

Before putting on headphones always adjust the volume setting to the lowest position.

Remember to leave the dome light switch in the off or auto positions when the vehicle is unattended, as the dome lights, if left on, can drain the vehicle's battery.

Do not put pressure on the screen.

Caution children to avoid touching or scratching the screen, as it may become dirty or damaged.

Patented: Refer to [www.voxintl.com/patents](http://www.voxintl.com/patents)





For Customer Service  
Visit Our Website At  
**[www.voxxelectronics.com](http://www.voxxelectronics.com)**  
Product Information, Photos,  
FAQ's, Owner's Manuals

# MTGBAVX10 /MTG13UHD

10.1" /13.3" Overhead LCD Monitor  
With Built-In DVD Player  
Owner's Manual

movies **toGo**  
by VOXX

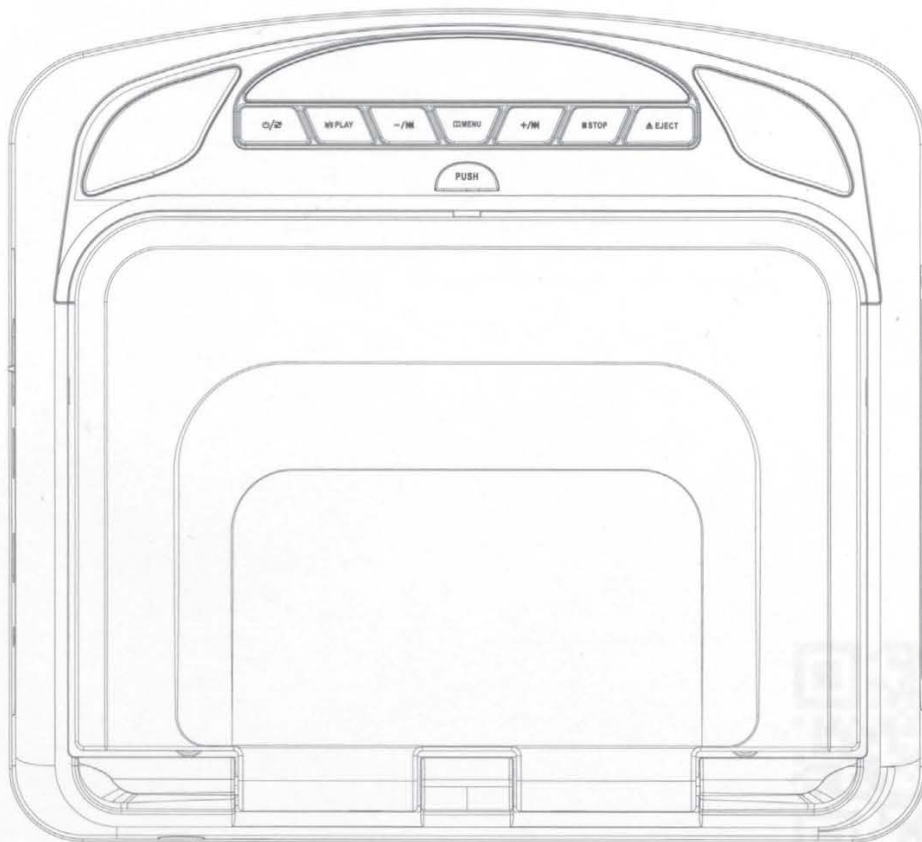

## Congratulations

Congratulations on your purchase of DVD Player with drop-down video / monitor. The MTG10UHD/MTG13UHD has been designed to provide passengers with unlimited content options delivering smiles for many miles. Please read the directions that follow to familiarize yourself with the product to ensure that you obtain the best results from your equipment.

**Note:** Installation options vary, see the individual owner's manuals for each component in your system to obtain a full understanding of each component's operation.

## Safety Precaution

For safety reasons, when changing video media, it is recommended that the vehicle is not in motion, and that you do not allow children to unfasten seat belts to change video media or make any adjustments to the system. System adjustments can be accomplished using the remote control, while seat belts remain fastened. Enjoy your entertainment system but remember the safety of all passengers remains the number one priority.

## Table of Contents

Features .....	6
Controls and indicators diagram(front view) .....	7
Controls and indicators diagram(side view) .....	9
Remote Control Operation .....	10
Remote Control Functions .....	10
Turning the unit on or off .....	15
Source menu .....	16
System Menu Setting and Adjustments .....	18
Playing DVDs and Audio Discs .....	25
Playing USB Devices .....	25
Playing MP3 Discs .....	26
DVD Basics .....	27
HDMI/MHL Devices.....	29
USB Input .....	30
Troubleshooting .....	31
Specifications.....	32
Warranty .....	33

## Features

- 10.1"/13.3" Digital Thin Film Transistor (TFT) Active Matrix Liquid Crystal Display LED Backlit Monitor
- Built-in DVD Player
- Last position memory for DVD Player
- Six Audio / Video Source Inputs  
DVD, USB, AV, AUX, HDMI/MHL 1, HDMI/MHL or SmartStream.
- USB 2.0 Port (User Accessible with Media Playback and Charging support)
- HD Input 1 (User Accessible with MHL support)
- HD Input 2 (Hidden Input via 24Pin Connector - Must be connected during Installation)  
Connection of HDMI/USB Remote access Harness  
Connection of SmartStream wireless content streaming Module
- On Screen Display (OSD) for control of picture quality and functions
- Full function remote control
- Plays DVD, CD and MP3 discs
- 100 Channel Wireless FM Modulator
- Dual Channel IR Transmitter
- M1/M2 Operation (for when 2 systems are installed in 1 Vehicle so that IR Headphone Audio and Remote Control operation is independent)

## Controls and indicators diagram (front view)

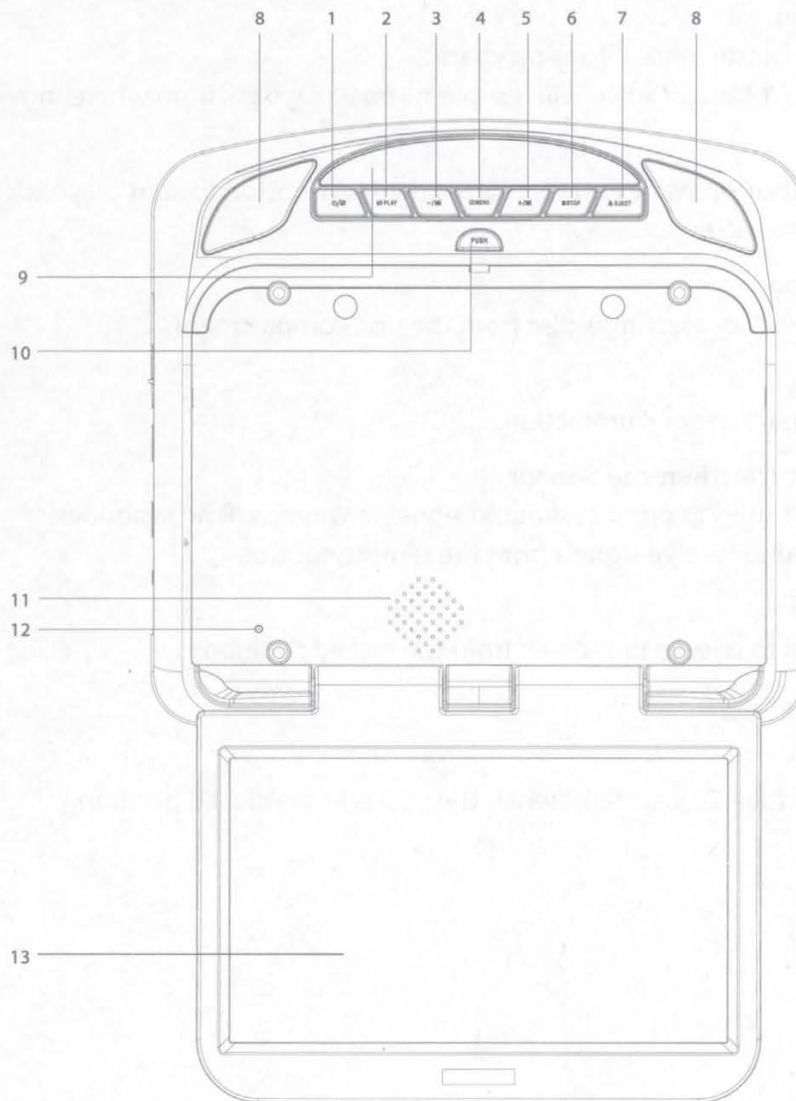

**1. POWER/SOURCE (⏻/📻) Button**

This button is used to turn the system on/off and to select the source .

**2. Play/Pause (▶/⏸) Button**

This button is used to start playback of a disc or pause a disc.

**3. DOWN / Previous (–/⏮) Button**

Short press to select the source mode and system menu pages.  
Long press to select previous chapter or track during play the DVD.

**4. MENU Select Button**

This button is used to display and select options on the system menu.

**5. UP/NEXT(+/⏭) Button**

Short press to select the source mode and system menu pages.  
Long press to select next chapter or track during play the DVD.

## Controls and indicators diagram (front view)-Continued

### 6. STOP (■) Button

-Press the STOP button once: Stops playback.

-Pressing the PLAY button again will resume normal playback from where movie was stopped.

-Press the STOP button twice and then press the PLAY button to start playback from the beginning of the DVD.

### 7. EJECT (▲) Button

This button is used for ejecting a disc from the disc compartment.

### 8. Dome Lights

Provide additional interior illumination.

### 9. Infrared Transmitter/Remote Sensor

*IR Transmitter:* is used to broadcast audio signal to wireless IR headphones.

*IR Sensor:* is used to receive signals from the remote control.

### 10. Screen Release

Push this button to release the screen from the locked position.

### 11. Ventilation Openings

### 12. LCD Off Switch

Used to turn off the LCD backlight when the LCD is in the closed position.

### 13. LCD Panel

## Controls and indicators diagram (side view)

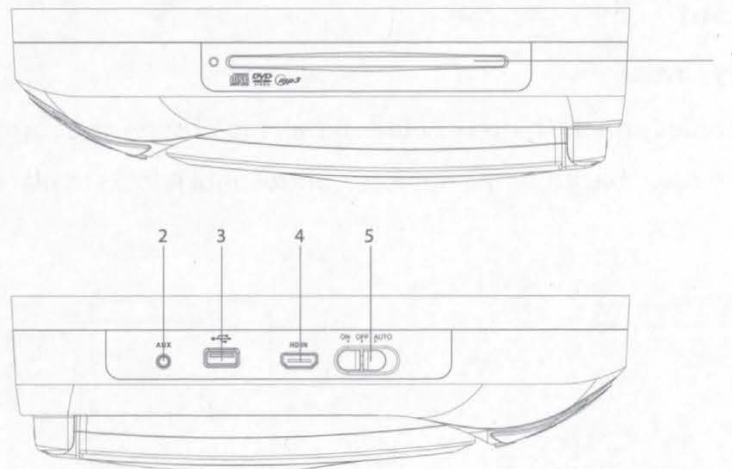

### 1. DVD Disc Insertion Slot

For loading and removing discs. When a disc is inserted, the unit will automatically turn ON and switch to DVD source. Insert a disc with label side facing up.

**Note:** The disc slot indicator is red when a disc is inserted and green when the disc slot is empty.

### 2. AUX IN

This jack is used to supply external audio and video inputs to the unit.

### 3. USB INPUT

For connection of a USB memory device. This input will also charge a USB device that contains a battery.

**Note:** The USB input supplies up to 2A of charging current. (Samsung Mobile Devices up to 500mA). It is recommended to connect the device to a vehicle power outlet for full charging capabilities.

### 4. HD INPUT

For connection of devices with HDMI/MHL outputs.

**Note:** Requires an HDMI/MHL enabled device and the appropriate adapter cable for that device. Contact your HDMI/MHL device supplier for the adapter.

### 5. THREE POSITION DOME LIGHT SWITCH

**ON** - Turns on the dome lights.

**OFF** - The dome lights will not turn on in this position.

**AUTO** - Automatically turns on the dome lights in conjunction with the vehicle's interior illumination.

## Remote Control Operation

### Battery Replacement

1. Remove the battery cover.
2. Insert two AAA batteries into the battery holder. Be sure to observe the correct polarity.
3. Reinstall the battery cover back into the Remote Control until it locks in place.

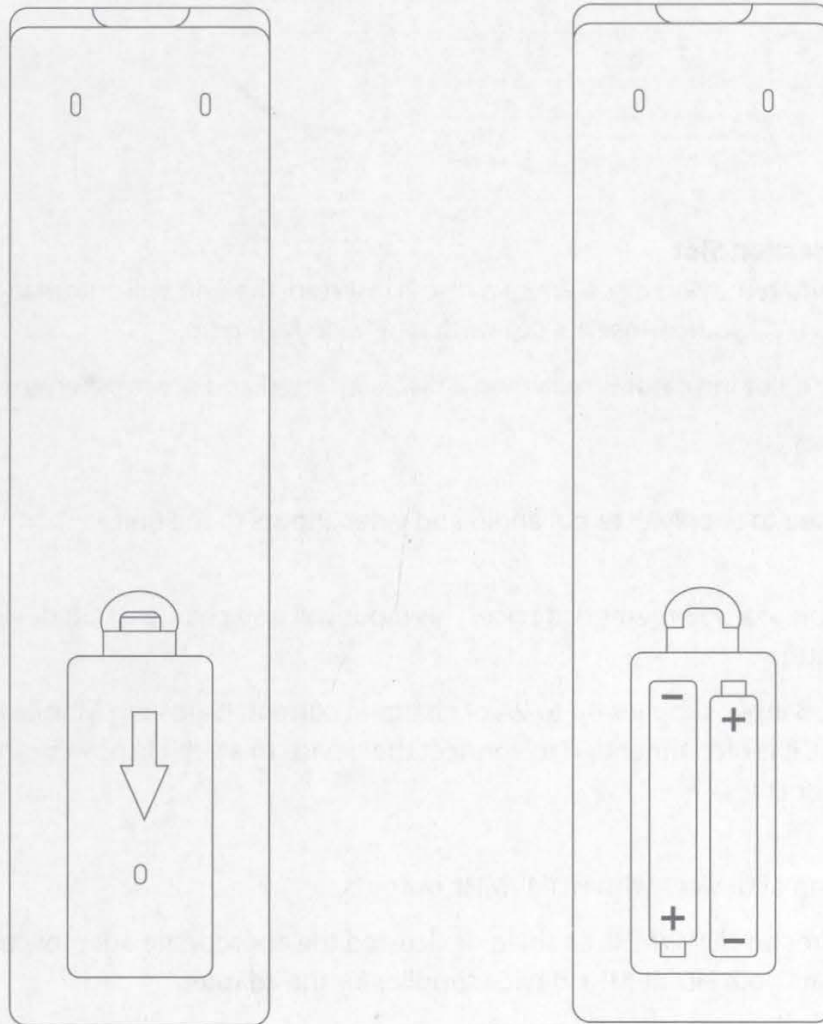

# Remote Control Functions

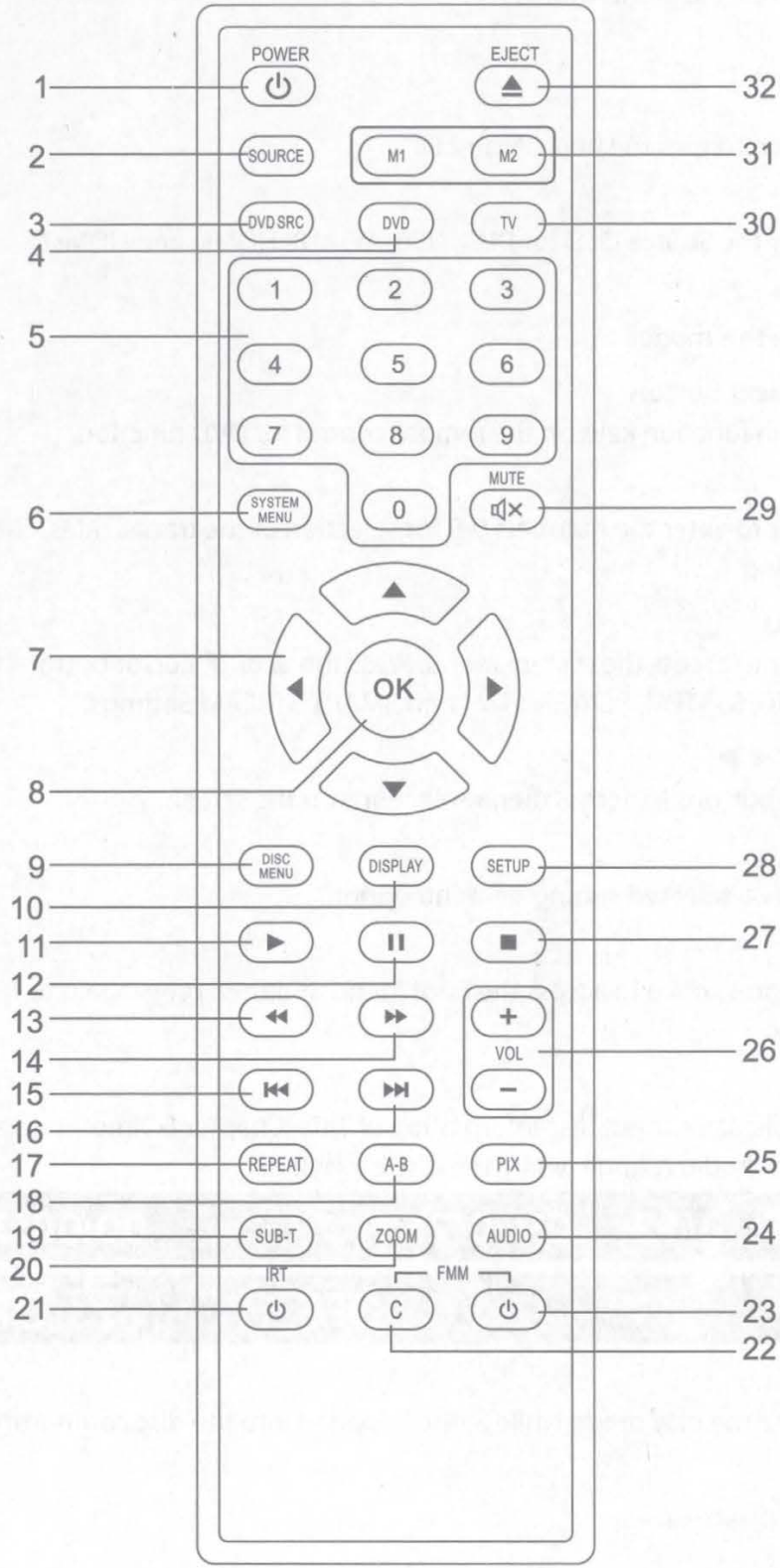

## Remote Control Functions(Continued)

\* Function control is available on the unit and the Remote Control.

\*\* Function not available in this model.

### 1. POWER\*

Press this button to turn the unit ON and OFF.

### 2. SOURCE\*

Press to display the Source OSD for DVD, USB, AV, AUX,HDMI1 and HDMI2.

### 3. DVD Source\*\*

No function on this model.

### 4. DVD Mode Select Button

Switches certain function keys on the remote control for DVD function.

### 5. NUMBERS

Allows the user to enter the numbers 0-9 for selection of the tracks, titles, chapters or password setting.

### 6. SYSTEM MENU

Allows the user to access the system menu. Press the ▲ or ▼ cursor buttons to select PICTURE, AUDIO, SYSTEM, PLAYER, FMM and SMART STREAM Settings.

### 7. CURSOR (▲▼◀▶)

Use the cursor buttons to access menu selections on the screen.

### 8. OK

Used to execute a selected setting or menu option.

### 9. DISC MENU

In DVD mode, press once to access the Root Menu and then press again to resume to previous screen.

### 10. DISPLAY

Press once to display current disc information of Title, Chapter & Time. Press again to display Subtitle, Audio & Angle while the disc is playing.



### 11. PLAY (▶)\*

Press to activate the play mode while a disc is loaded into the disc compartment.

### 12. PAUSE (II)\*

Press to pause playback.

### 13. BACKWARD (◀◀)

Press to search in a backward direction. Press repeatedly to change the search speed from 2, 4, 8, 20 times and normal speed.

## Remote Control Functions(Continued)

### 14. SCAN FORWARD (▶▶)

Press to search in a forward direction. Press repeatedly to change the search speed from 2, 4, 8, 20 times and normal speed.

### 15. PREVIOUS (◀◀)

Press to return to the previous chapter or track.

### 16. NEXT (▶▶)

Press to skip to the next chapter or track.

### 17. REPEAT

Allows the user to repeat a selected chapter, title or all track.

### 18. A-B REPEAT

Allows user to repeat the playback from point A to point B.

Press A-B button

On-Screen Display

DVD player

Once

Repeat A

Mark the beginning of the section to repeat (Set point A)

Twice

A-B

Mark the end of the section to repeat (Set point B)

3 times

AB Off

Cancel the A-B repeat function

### 19. SUBTITLE

Press to display and select the subtitle language in DVD mode. Each time this button is pressed, the subtitle language changes. Pressing the button will also turn the subtitles off.

**Note:** The type and number of subtitle languages vary from disc to disc.

### 20. ZOOM

Press this button to enlarge or decrease the picture size when playing a DVD disc.

**Press ZOOM button**

**DVD Player performs**

1 Time

Enlarges the picture 2X

2 Times

Enlarges the picture 3X

3 Times

Enlarges the picture 4X

4 Times

Reduces the picture 1/2

5 Times

Reduces the picture 1/3

6 Times

Reduces the picture 1/4

7 Times

Picture is returned to original size

### 21. IRT ON/OFF

Turns the Infrared Transmitter on/off for IR wireless headphones.

### 22. FM MODULATOR CHANNEL SELECT (C)\*\*

No function on this model.

User may use the system menu to select the FM Modulator.

### 23. FMM ON/OFF

Turns the FM Modulator power on/off.

## Remote Control Functions(Continued)

### 24. AUDIO

Press to display and select audio language in DVD mode. Each time this button is pressed, the language changes.

### 25. PIX ( Picture Select )

This button is used to make picture adjustments. Use the UP or DOWN direction buttons to select BRIGHTNESS, CONTRAST,COLOR, TINT, or RESET. Use the UP or DOWN buttons to adjust the setting. The OSD will automatically disappear if no adjustments are made within 6 seconds.

### 26. VOLUME DOWN (-) or UP (+)\*\*

No function on this model.

### 27. STOP (■)\*

Press to stop playback. (Playback will resume from the point it is stopped).

Press twice to stop playback fully. (Playback will resume from the beginning of the disc).

**Note:** For MP3 or photo mode, press twice to return to Audio/Photo/Video option menu.

### 28. SETUP\*\*

No function on this model.

User can use the system to select the function may need.

### 29. MUTE

Press this button to mute the audio for the wireless FM Modulator, IR headphones and audio output.

Pressing the button again restores the audio to the previously set level.

### 30. TV Mode Select

Switches certain function keys on the remote control for monitor functions.

### 31. MONITOR SELECT

**M1 Button** – Set the remote control code to allow control of the unit in M1 mode.

**M2 Button** – Set the remote control code to allow control of the unit in M2 mode.

**Note: M1/M2 operation is only for when 2 systems are installed in the same vehicle.  
This allows independent Remote Control and independent playback of audio  
for each system..**

### 32. EJECT (▲)\*



Press this button to eject the disc.

## Turning the unit on or off

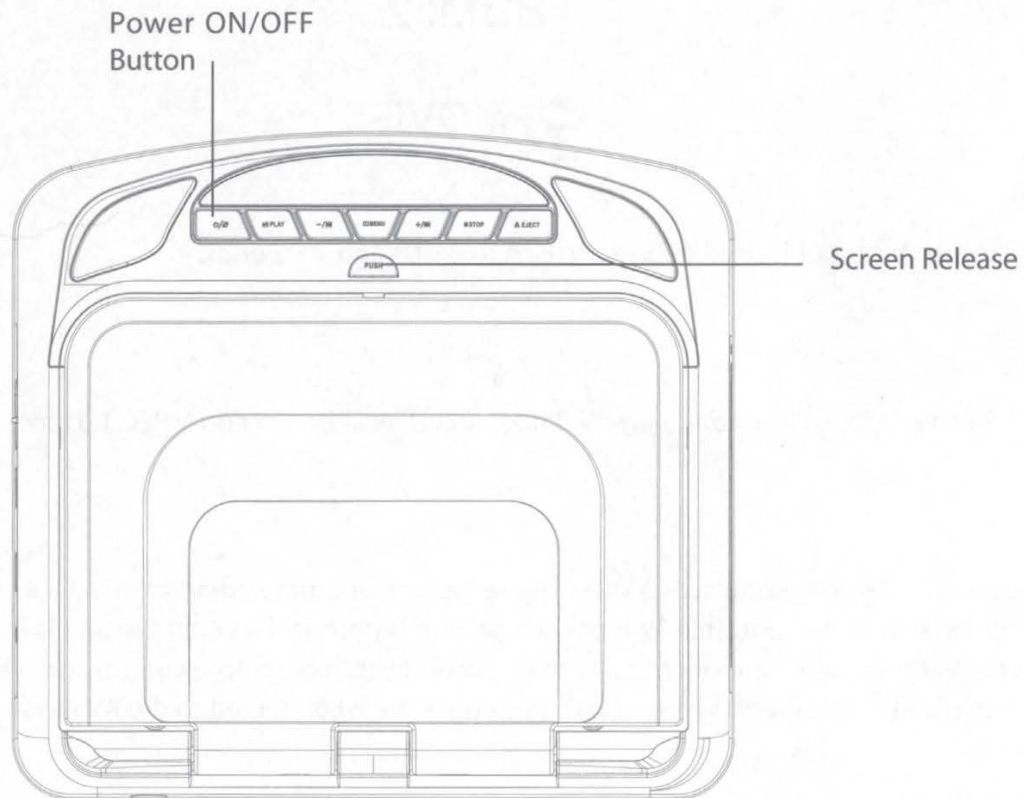
1. Push in the Screen Release button to unlock the LCD screen. The screen will drop down slightly.
2. Pivot the screen downward until a comfortable viewing angle is reached. The hinge friction will hold the screen in position while the system is in use.
3. Press the power button on the unit or the remote control to turn the system on and off. When in use, the internal backlighting will illuminate the controls.
4. After the unit has been turned on and is displaying a picture, adjust the viewing angle by pivoting the screen to optimize the picture quality.
5. Remember to turn the unit off and pivot the LCD screen to the locked position when not in use.



## Source Menu

The System is capable of accessing six source inputs. To select or change a source, press the source  button on the front panel or the Source button on the remote control. The source OSD will appear on the screen as shown in the figure below. Use the + or - cursor buttons on the front panel or the ▲ or ▼ cursor buttons on the remote control to highlight a source. Press the Source  button on the front panel or the OK button on the remote control to select the desired source.



### DVD

The DVD source input is used to play DVDs, Audio CDs and MP3 discs.

### USB

The USB source input is used to play MP3 files, JPEG files (Photos) and MPEG I, II files.

### AV

An external video source such as a video game system, or other audio/video devices can be connected to the AV input. This AV input connection is performed when the unit is installed. Turn the video source component on with its power button or remote control and it is now ready to play the audio and video signals from the source connected to the AV input.

### AUX

An external video source such as a video game system or other audio/video devices may be connected to the system via the AUX input. Connect your peripheral device to the supplied Aux Adapter harness and plug the harness into the AUX Input on the side of the system. Turn the external source component on with its power button or remote control and it is now ready to play the audio and video signal from the source connected to AUX.

## Source Menu(Continued)

### HDMI 1 & HDMI 2

These Source inputs allow the user to enjoy high-definition digital images and high-quality sound by connecting a HD device such as a Blu-ray player or smartphone with an HDMI output to the system. The HDMI inputs also allow the user to connect with a Mobile High-Definition Link (MHL) mobile phone. Connect your HDMI/MHL device with an optional HDMI cable. Smartphones and Tablet require the appropriate adapter for your smart device. You can also use this input to connect a Smart Stick such as a ROKU, Amazon FireTV and Chromecast device (these devices may require Wi-Fi Hotspot access to stream content which is not included with this system).

#### Notes:

- This source requires an HDMI/MHL enabled device and a special HDMI/MHL adapter. Contact your HDMI/MHL device supplier for the adapter.
- Phone functionality (phone calls, texting, etc.) may be limited while using the adapter.
- HDMI content is copy protected and is not available on the AV output of the System.

## System Menu Setting and Adjustments

The Setup Menu contains features and options that let you customize your DVD player. For example, you can set a language for the on-screen display or set up PARENTAL controls to control DVD playback for children.

### Using the System Menu

1. Press the System Menu button on the remote. The System Menu appears on the screen as shown in the figure below. There are 6 icons that will appear individually in the upper left hand corner of the System Menu as each option is selected.

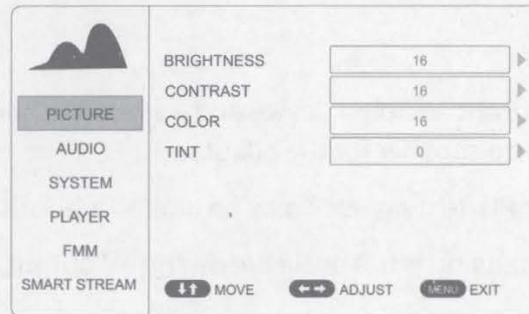

2. To select the desired setup option, move the highlighted (in blue) option using the up/down (▲▼) cursor buttons. Press the right (▶) cursor button to access the options on the right hand side of the screen.
3. After entering the setup area (on the right side of the screen), highlight the desired option using the up/down (▲▼) cursor buttons.
4. Press the right (▶) cursor button to toggle the sub menu that contains the different options available.
5. Repeat steps 3 and 4 to set the options for each option on the same Setup Page.
6. To change to another Setup page, press the system menu cursor button to the icon side of the setup page. Then, repeat steps 2 through 5.

## System Menu Setting and Adjustments(Continued)

7. If without a Remote control user can use the local key to select the function setting.
  - a.) Menu = Long press to call up the setup menu screen information or return/exit the system menu  
= Short press function as Down Key
  - b.) ►/|| Play = Enter Key
  - c.) -/◀ = Left Key
  - d.) +/▶ = Right Key

### PICTURE CONTROL

The PICTURE setup functions allows the user to select and set the picture control function.

BRIGHTNESS, CONTRAST, COLOR adjustments range from 0 to 32.

TINT adjustments range from -16 to 16.

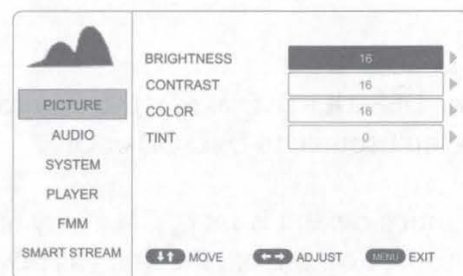

### AUDIO MODE

The AUDIO setup functions allows the user to select and set the IRT Headpone transmitter "ON" or "OFF".

### IRT

The IR transmitter can be set to ON or OFF. The IR Transmitter must be set to "ON" for the wireless headphone to be operational.

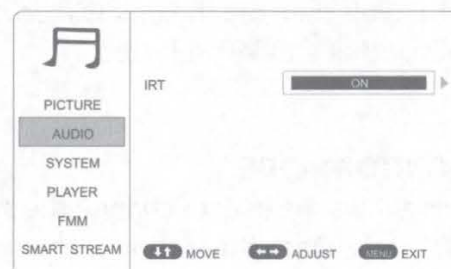

## System Menu Setting and Adjustments(Continued)

### SYSTEM MODE

The system setup function allow the user to select the system function. Functions listed below.

### LANGUAGE

The LANGUAGE setup allows the user to select ENGLISH,SPANISH, FRENCH, GERMAN for the on-screen language display.

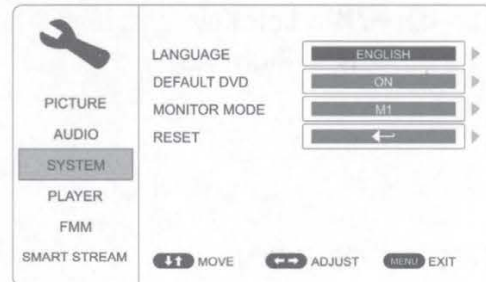

### DEFAULT DVD

The DEFAULT DVD allows the user to set the system default source to DVD ON or OFF.

If souce default is set to ON, every time the unit is turned off the on, the unit will power up and automatically switch the source to DVD.

If source default is set to OFF and the system is turned off then on, the unit will power up in the source that was last selected.

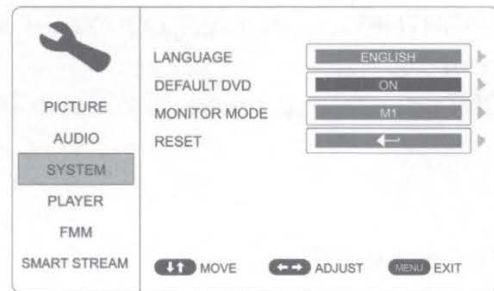

### MONITOR MODE

This allows the user to change the system to M1 or M2 mode. Once the setting is changed, the remote control and IR headphones will only work if set to that same setting.

1.M1 Mode - For the Remote Control to operate the system when set to M1, press the M1 button on the Remote Control.

Please make sure IR Headphones are set to Channel A when the system is in M1 mode.

2.M2 Mode - For the Remote Control to operate the system when set to M2, press the M2 button on the Remote Control.

Please make sure IR Headphones are set to Channel B when the system is in M2 mode.

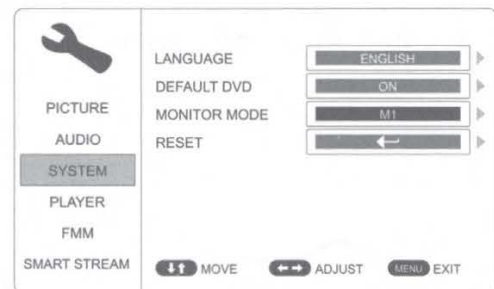

## System Menu Setting and Adjustments(Continued)

### RESET

The RESET functions allows all settings options to be reset to factory settings.

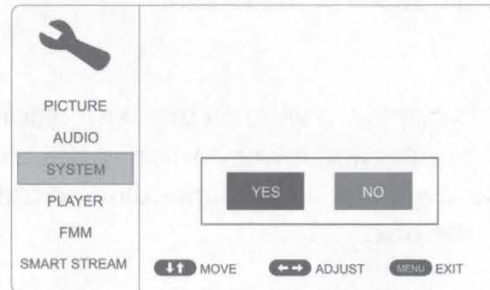
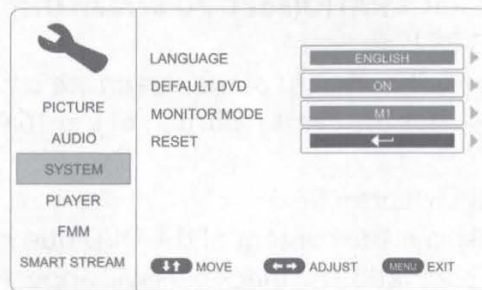

### PLAYER MODE

The Player setup function allow the user to select DVD functionality.

### TV SYSTEM

The TV SYSTEM setup allows the user to choose television standard which corresponds to your TV.

NTSC-Select this type for NTSC TV

PAL-Select this type for PAL TV

AUTO-Select this type if the connected screen is a multi-system TV. The video format of the disc (NTSC or PAL) will determine the video signal output.

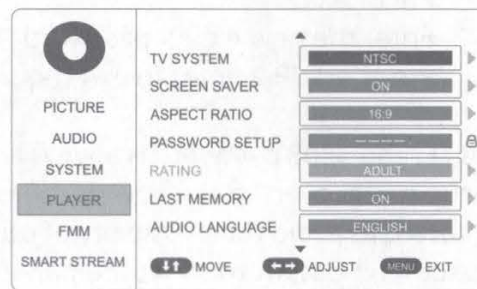

### SCREEN SAVER

This allows you to set the Screen Saver mode.

ON -Screen Saver will appear

OFF -Screen Saver will not appear

**Note:** The DVD player will enter Screen Saver mode if the unit is inactive for approximately 2 minutes.

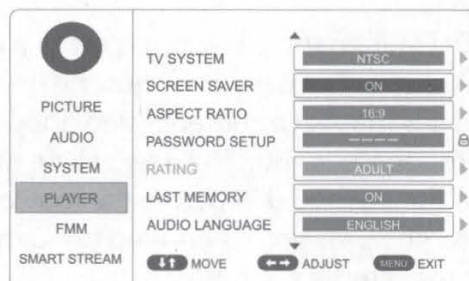

## System Menu Setting and Adjustments(Continued)

### ASPECT RATIO(For DVD Screen Display)

#### 4:3 PS (Pan Scan)

The left and right of the screen are cut off and displays the central portion of the 16:9 screen.

#### 4:3 LB (Letter Box)

Displays the content of the DVD title in the 16:9 aspect ratio. The black bars will appear at the top and bottom of the screen.

#### 16:9

This displays a wide picture with black bands on the upper and lower portion of the screen. The bandwidth will vary, depending on the aspect ratio of the disc.

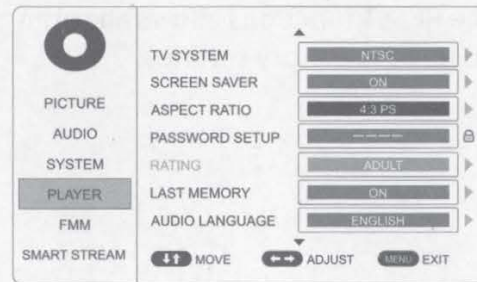

### PASSWORD SETUP

The default password is 3308. To change the rating of the DVD player press 3308 to access the RATING setting.

**NOTE:** 3308 must be pressed to set a new password.

- Press 3308
- Enter the new 4 digit password
- Press SETUP 2 times to exit the setup mode.

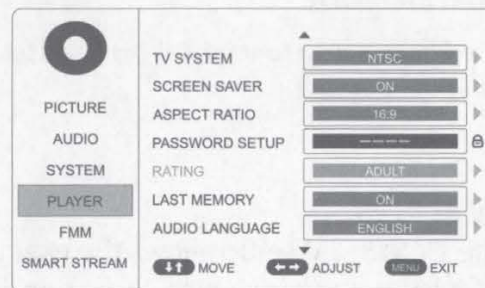

**NOTE:** The 3308 password is always accepted in the setup menu even after a new password has been entered. To avoid the possibility of others using the default password to set the parental level and change the password, record this default password in another area and delete it from this manual. The restriction of viewing disc content by younger users may be available on some discs, but not on others.

**NOTE:** When the password is set to a new password, that password must be used to play movies that have content rated above the setting in the setup menu. The user will be prompted to put the password in before the movie can play. After the password is entered press the OK button on the remote control.

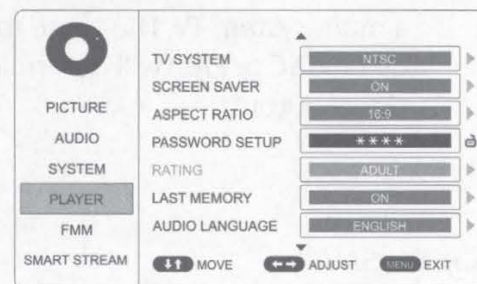

## System Menu Setting and Adjustments(Continued)

### LAST MEMORY

The last memory function allows DVD playback to begin from the point when playback was last stopped. The last memory feature allows the user to turn the last memory feature function on or off.

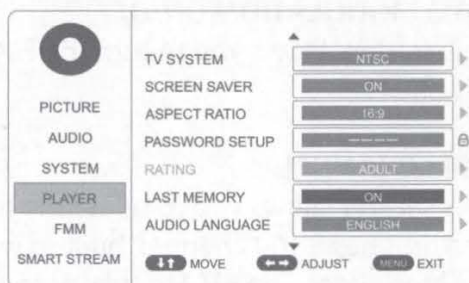

### AUDIO LANGUAGE

This setting allows you to select a preferred audio language. This function only applies to discs encoded with different audio languages.

Options: ENGLISH, FRENCH, SPANISH and GERMAN.

**NOTE:** If the selected language is not available for the currently playing disc, the disc's default setting is applied.

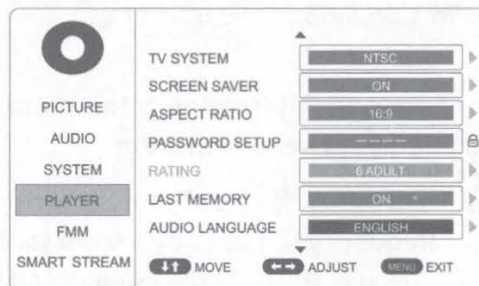

### SUBTITLE LANGUAGE

This setting allows you to select a preferred subtitle language. This function only applies to discs encoded with subtitles. Options: ENGLISH, FRENCH, SPANISH, GERMAN and OFF.

**NOTE:** If the selected language is not available for the currently playing disc, the disc's default setting is applied.

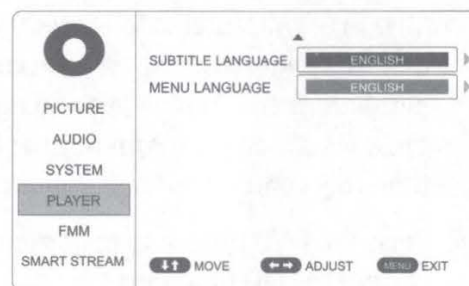

### MENU LANGUAGE

This setting allows you to select a preferred disc menu language.

Options: ENGLISH, FRENCH, SPANISH and GERMAN.

**NOTE:** If the selected language is not available for the currently playing disc, the disc's default setting is applied.

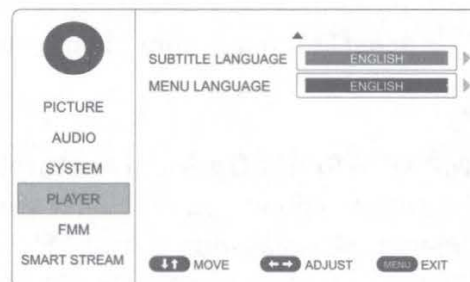

## System Menu Setting and Adjustments(Continued)

### FMM MODULATION(ON/OFF)

This setting allows you to turn the FMM modulator ON or OFF.

### FMM CHANNEL

This setting allows you to select the frequency. The unit has a 100 channel built-in wireless FM Modulator. The FM Modulator can be set from 88.1MHz to 107.9MHz in 0.2MHz steps, i.e.88.1,88.3,88.5,88.9,90.1 etc.

### To choose an FM frequency for audio playback through your vehicle's radio:

1. Use the ▲ ▼ ◀ or ▶ cursor buttons to select a frequency not used by a radio station in the area. Press OK to select the highlighted frequency. There are a total of 3 FM CHANNEL pages containing frequencies from 88.1 MHz to 107.9 MHz in 0.2 MHz steps. To access the additional FM Channel pages, use the ◀ or ▶ cursor buttons to highlight the on screen left and right arrows and press OK. Once the frequency has been selected, tune the vehicle's radio to the selected frequency.
2. Press the DVD button to restore the remote control to DVD functions.

**Note:** The wireless FM modulator will perform well in most applications. However, in certain geographical areas the quality of the wireless signal may be less than optimal, resulting in static or strong local station bleed through. If this is a consistent problem, an FMDIRB (hard wired FM connection) can be installed by your dealer.

### SMART STREAM(Optional Feature)

This setting allows you to select Wireless Streaming Display Mode. Press YES to enter the Wireless Streaming Display Mode or press NO to exit.

**Note:** The SmartStream Wireless Streaming Display feature will only work when optional module WM1 is connected to the system. Please refer to the SmartStream manual for user operation.

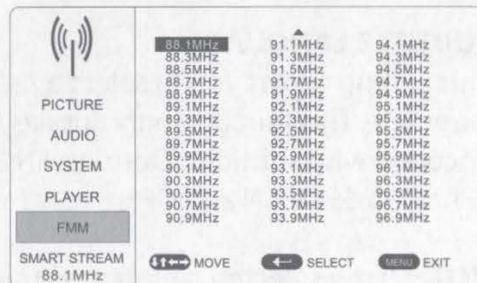
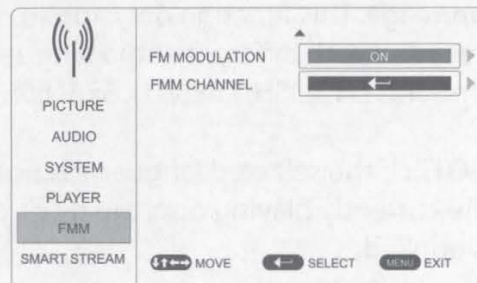
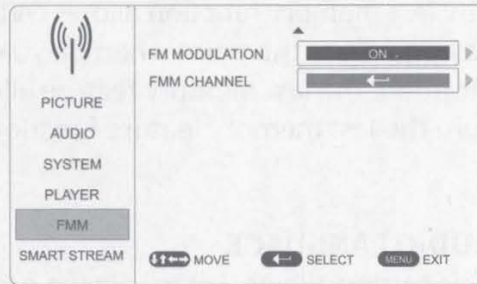

## Playing DVD and Audio Discs

### Playing DVDs

When a disc is loaded. Press the DISPLAY button on the remote control to display the status banner. The status banner includes the disc title, chapter audio language , subtitle & angle.

Title Selection: Some DVDs contain more than one title (e.g. sitcoms, collections, etc.)

Press the numeric (0-9) buttons to initiate a change of chapter title selection.

Using the repeat feature to select OFF, Chapter, Title and Repeat All to play the movies contents.

### Playing Audio CDs

When playing an audio CD, the DISPLAY banner appears automatically. The track number and the elapsed time of the disc are displayed.

Selecting a Track: Selection of a specific track is accomplished by using the numbers keys. Press the number key corresponding to the desired track and the player will implement the selection.

- Press the previous button (⏮) to return to the previous chapter or track.
- Press the next button (⏭) to skip to the next chapter or track.

### Using the REPEAT feature

The default mode for the Repeat feature is OFF. Pressing REPEAT on the remote control consecutively changes the repeat options.

- OFF Plays all songs on the disc and stops after all songs are played
- REP 1 Repeats 1 song
- REP DIR Plays songs in the directory
- REP ALL Plays all songs on the disc repeatedly

### Playing USB Devices

To play a USB device, change the source to USB and plug a USB device into the USB port. When a USB device is inserted into the player the navigation menu appears automatically.

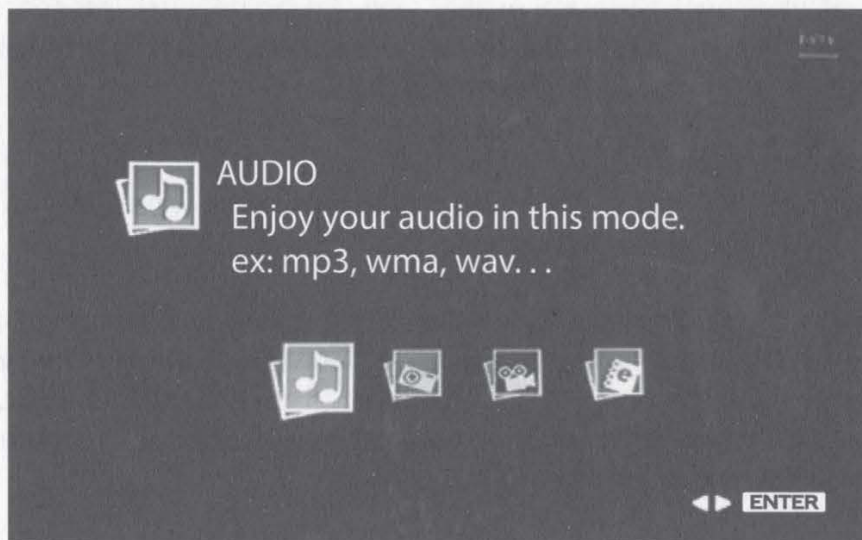

## Playing DVD and Audio Discs

Use the cursor keys ▲ ▼ ◀ or ▶ and OK to navigate the on screen menus.

The USB port can play AUDIO, PHOTO, VIDEO . The following formats are supported:

### Audio

- MP3
- WMA
- AAC

### Photo

- JPEG
- BMP

### Video\*

- AVI (MPEG4-DIVX (DIVX 4.0/5.0), MPEG4-XVID - (720 x 576 max resolution)
- MPG (MPEG-1) - (720 x 576 max resolution)
- MOV (MPEG4-DIVX) - (720 x 576 max resolution)
- FLV (FLV1) - (720 x 576 max resolution)
- SWF (FLV1) - (720 x 576 max resolution)
- DAT (MPEG1) - (720 x 576 max resolution)
- VOB (MPEG2) - (720 x 576 max resolution)

Note: All formats may not play depending on the software used to convert the video file from its original format.

## Playing MP3 Discs

### Playing MP3 Discs

MP3 is a format for storing digital audio. An audio CD-quality song can be compressed into MP3 format with very little loss of quality, while taking up much less space. CD-R discs that have MP3 format files can be played on the DVD player. The DVD player plays the songs in the order they were burned on to the disc.

### Selecting Folders and Songs:

When an MP3 disc is loaded in the player, the navigation menu will appear on the screen automatically and a song will start playing.

To change songs use the ▲▼arrows to select a different song and press the OK or ◀ button to play the selected song. To change folders press the ▲ button to move to the root folder and press the OK or ◀ button to display all the folders on the disc. Use ▲▼ the buttons to select a new folder and press the OK or ◀ button to enter the new folder. The unit will begin playing the first song of the folder.

## DVD Basics

To get the optimum use out of the DVD Player, please read the following:

### DVD Region Code

The DVD player is preset to a region code at the factory depending on where the DVD player is sold. A DVD from a different region cannot be played in this unit and the unit will display "WRONG REGION".

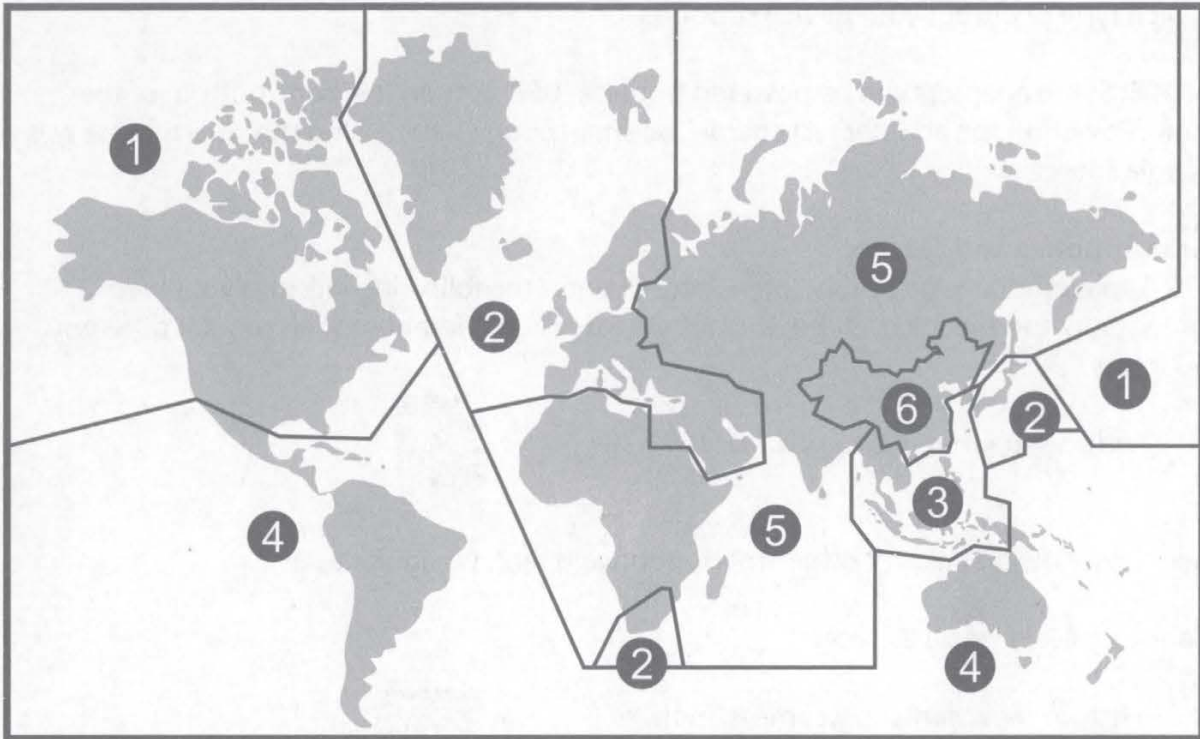

*Region 1*- USA, Canada

*Region 2*- Japan, Europe, South Africa, Middle East, Greenland

*Region 3*- S. Korea, Taiwan, Hong Kong, Parts of South East Asia

*Region 4*- Australia, New Zealand, Latin America (including Mexico)

*Region 5*- Eastern Europe, Russia, India, Africa

*Region 6*- China

## DVD Basics

### HDMI (HDMI/MHL)

An HD Input is located on the side of the unit.

This input can be used for devices with HDMI or MHL output ports (such as smartphones, tablets and HDMI devices) and may require the purchase of an HDMI cable and HDMI adapter which is available from your device manufacturer. Each device has unique requirements, please consult with your device or smartphone manufacturer to determine which type of output your device supports.

**NOTE:** Some adapters can be powered from the USB port on the front/bottom of the unit. Powering the adapter will charge the smartphone when using the smartphone as a media source.

#### Smartphones and Tablets

For Apple products, go to the Apple Store or enter the following link into your web browser to find the adapter required for your device. Different models require different adapters.

• <http://support.apple.com/kb/ht4108> \*



See the following links for other smartphone and tablet manufacturers:

Samsung Multimedia adapter:

• <http://www.samsung.com/us/mobile/cell-phones-accessories/multimedia-adapters>



**NOTE:** Some Samsung smartphones may require an additional 5-pin micro USB to 11-pin micro USB adapter in addition to the multimedia adapter.

For other smartphone makes and models check with your device service provider to find an adapter that will work with your device.

Amazon is a good source for finding an adapter that will work with your smartphone.

## HDMI Devices

### HDMI Devices \*\*:

Amazon FireTV Stick streaming device:

- [www.amazon.com](http://www.amazon.com) and search for FireTV Stick



Chromecast media streaming device:

- [www.google.com](http://www.google.com) and search for Chromecast



Roku HDMI streaming device:

- <http://www.roku.com/products/compare>



MHL devices\*\*:

Roku MHL Streaming Stick

- <http://www.roku.com/roku-ready/models>\*



Note: does not require external power but must be purchased with the Roku remote control

## USB Inputs

### USB1 Port(User Accessible)

The USB port provides two functions:

1. Media port for USB thumb drives:
2. charging:
  - The USB port will not charge a portable device when the unit is turned OFF.
  - The USB port will charge a portable device in the following modes:
    - DVD/USB (Not recommended)
    - AV
    - AUX
    - HDMI/MHL
  - It will not charge in USB mode.
  - For Apple /Android Mobile , It will charge at up to 2 Amps of charging current.
  - For Samsung Mobile, It will charge at up to 500mA of charging current.

### USB2 Port(Hidden Input for when remote HDMI/USB Harness HDH12 is Installed)

1. The USB port charging only.
2. Max Charging current  
For Apple /Android Mobile , It will charge at up to 2 Amps of charging current.  
For Samsung Mobile, It will charge at up to 500mA of charging current.
3. Charging is available in all source.
4. USB2 is not a source, so it can't be selected in the Main Menu or Source.

## Troubleshooting

PROBLEM	SOLUTION
IR remote inoperative	<ul style="list-style-type: none"> <li>• Verify that the battery in the remote is fresh.</li> <li>• Verify that the remote sensor eye is not obstructed.</li> </ul>
Disc won't play	<ul style="list-style-type: none"> <li>• Insert a disc with the label side facing the viewer.</li> <li>• Check the type of disc you put into disc tray. This DVD only plays DVD, audio CD and MP3s.</li> <li>• Both the unit and the disc are coded by region. If the regional codes don't match, the disc can't be played.</li> </ul>
Play starts, but then stops immediately	<ul style="list-style-type: none"> <li>• The disc is dirty. Clean it.</li> <li>• Condensation has formed. Allow player to dry out.</li> </ul>
No sound or distorted sound	<ul style="list-style-type: none"> <li>• Make sure your DVD is connected properly. Make sure all cables are securely inserted into the appropriate jacks.</li> <li>• If you are using the 2-channel IR headphones, make sure you turn on the IR headphone power, make sure the correct channel (A or B) is selected.</li> <li>• If the FM Modulator is ON make sure proper frequency has been selected.</li> </ul>
Cannot advance through a movie	<ul style="list-style-type: none"> <li>• Most discs prohibit advancing through the opening credits and warning information that appear at the beginning of movies.</li> </ul>
The icon (⊘) appears	<ul style="list-style-type: none"> <li>• The feature or action cannot be completed at this time because:               <ol style="list-style-type: none"> <li>1. The disc's software restricts it.</li> <li>2. The disc's software doesn't support the feature (e.g., angles)</li> <li>3. The feature is not available at the moment.</li> <li>4. A title or chapter number that is out of range has been requested.</li> </ol> </li> </ul>
Picture is distorted	<ul style="list-style-type: none"> <li>• The disc might be damaged. Try another disc.</li> <li>• It is normal for some distortion to appear during forward or reverse scan.</li> </ul>

## Specifcaitions

### For MTG10UHD

Type	TFT Active Matrix LCD
Resolution	1024 (RGB) (X3) x 600
Pixels	1,843,200
Operation Temperature	32 ~ 113° F (0 ~ 45° C)
Storage Temperature	-4 ~ 149° F (-10 ~ 65° C)
Backlit life	20,000 Hours
Video Display System	NTSC / PAL / AUTO
Video Output	1.0Vp-p @ 75 ohms
Power Source	12VDC
Dimension (L x W x H)	297mm x 272mm x 77mm 16.7in x 10.7in x 3in

### For MTG13UHD

Type	TFT Active Matrix LCD
Resolution	1920 (RGB) (X3) x 1080
Pixels	6,220,800
Operation Temperature	32 ~ 113° F (0 ~ 45° C)
Storage Temperature	-4 ~ 149° F (-10 ~ 65° C)
Backlit life	20,000 Hours
Video Display System	NTSC / PAL / AUTO
Video Output	1.0Vp-p @ 75 ohms
Power Source	12VDC
Dimension (L x W x H)	375mm x 330mm x 77mm 14.8in x 13.0in x 3in

Specifications subject to change without notice.



## 12 MONTH LIMITED WARRANTY

*Applies to Movies To Go Mobile Video Products*

VOXX ELECTRONICS CORP. (the Company) warrants to the original retail purchaser of this product that should this product or any part thereof, under normal use and conditions, be proven defective in material or workmanship within 12 months from the date of original purchase, such defect(s) will be repaired or replaced with reconditioned product (at the Company's option) without charge for parts and repair labor. A game controller, if supplied, is similarly warranted for ninety (90) days.

To obtain repair or replacement within the terms of this Warranty, the product is to be delivered with proof of warranty coverage (e.g. dated bill of sale), specification of defect(s), transportation prepaid, to the Company at the address shown below.

This Warranty does not extend to the elimination of externally generated static or noise, to correction of antenna problems, to costs incurred for installation, removal or reinstallation of the product, or to damage to digital memory/media devices, gaming devices, discs, speakers, accessories, or vehicle electrical systems.

This Warranty does not apply to any product or part thereof which, in the opinion of the Company, has suffered or been damaged through alteration, improper installation, mishandling, misuse, neglect, accident, or by removal or defacement of the factory serial number/bar code label(s). THE EXTENT OF THE COMPANY'S LIABILITY UNDER THIS WARRANTY IS LIMITED TO THE REPAIR OR REPLACEMENT PROVIDED ABOVE AND, IN NO EVENT, SHALL THE COMPANY'S LIABILITY EXCEED THE PURCHASE PRICE PAID BY PURCHASER FOR THE PRODUCT.

This Warranty is in lieu of all other express warranties or liabilities. ANY IMPLIED WARRANTIES, INCLUDING ANY IMPLIED WARRANTY OF MERCHANTABILITY, SHALL BE LIMITED TO THE DURATION OF THIS WRITTEN WARRANTY. ANY ACTION FOR BREACH OF ANY WARRANTY HEREUNDER INCLUDING ANY IMPLIED WARRANTY OF MERCHANTABILITY MUST BE BROUGHT WITHIN A PERIOD OF 24 MONTHS FROM DATE OF ORIGINAL PURCHASE. IN NO CASE SHALL THE COMPANY BE LIABLE FOR ANY CONSEQUENTIAL OR INCIDENTAL DAMAGES FOR BREACH OF THIS OR ANY OTHER WARRANTY. No person or representative is authorized to assume for the Company any liability other than expressed herein in connection with the sale of this product.

VOXX Electronics Corporation,  
180 Marcus Blvd Hauppauge, NY 11788 1-800-645-4994

## Warnings

Do not use any solvents or cleaning materials when cleaning the video monitor.

Do not use any abrasive cleaners, they may scratch the screen.

Use only a lightly dampened lint free cloth to wipe the screen if it is dirty.

Lock the LCD screen in the fully closed position when not in use.

Before putting on headphones always adjust the volume setting to the lowest position.

Remember to leave the dome light switch in the off or auto positions when the vehicle is unattended, as the dome lights, if left on, can drain the vehicle's battery.

Do not put pressure on the screen.

Caution children to avoid touching or scratching the screen, as it may become dirty or damaged.

Patented: Refer to [www.voxxintl.com/patents](http://www.voxxintl.com/patents)





For Customer Service  
Visit Our Website At  
**[www.voxxelectronics.com](http://www.voxxelectronics.com)**  
Product Information, Photos,  
FAQ's, Owner's Manuals

# PRODUCT REGISTRATION

Thank you for purchasing an Voxx Electronics product. We pride ourselves on the quality and reliability of all our electronic products but if you ever need service or have a question, our customer service staff stands ready to help. Contact us at [www.voxxelectronics.com](http://www.voxxelectronics.com)

✓ **PURCHASE REGISTRATION:** Registering On-line will allow us to contact you in the unlikely event a safety notification is required under the Federal Consumer Safety Act.



**REGISTER ONLINE AT:**  
[www.voxxelectronics.com](http://www.voxxelectronics.com)

Click on Product Registration and Fill Out the Brief Questionnaire

# ENREGISTREMENT DU PRODUIT

Merci d'avoir acheté un produit Voxx électroniques.  
Nous sommes fiers de la qualité et de la fiabilité de tous nos produits électroniques, mais en cas de nécessité de réparation ou pour toute question, le personnel de notre service clientèle est prêt à vous aider. Contactez-nous sur [www.voxxelectronics.com](http://www.voxxelectronics.com)

✓ ENREGISTREMENT D'ACHAT: Enregistrer votre produit en ligne nous permettra de communiquer avec vous pour tout avis de sécurité au sujet du produit en vertu du Federal Consumer Safety Act (Loi fédérale de protection du consommateur).



**ENREGISTREZ VOTRE  
PRODUIT EN LIGNE SUR:  
[www.voxxelectronics.com](http://www.voxxelectronics.com)**

Cliquez sur Enregistrement produit et remplissez le court questionnaire

# ENREGISTRO DEL PRODUCTO

Gracias por comprar un producto Voxx electrónicos.  
Nos enorgullece la calidad y fiabilidad de todos nuestros productos electrónicos, pero si alguna vez necesita servicios técnicos o si tiene alguna pregunta, nuestro personal de atención al cliente está a su disposición para ayudarle. Comuníquese con nosotros en [www.voxxelectronics.com](http://www.voxxelectronics.com)

✓ REGISTRO DE COMPRA: El registro en línea nos permitirá comunicarnos con usted en el caso de tener que enviarle algún aviso de seguridad en virtud de la Ley Federal de Seguridad del Consumidor.



**REGISTRE EL PRODUCTO  
EN LÍNEA EN:  
[www.voxxelectronics.com](http://www.voxxelectronics.com)**

Haga clic en Registro del producto y responda al cuestionario

132-7865