

Source Unit

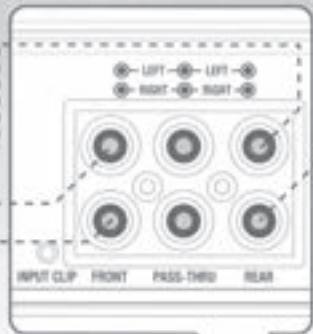

*Keep grounds as short as possible



Switched 12V to REM

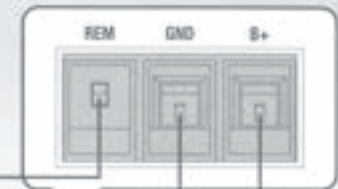

Connect to chassis ground of vehicle

*Keep grounds as short as possible

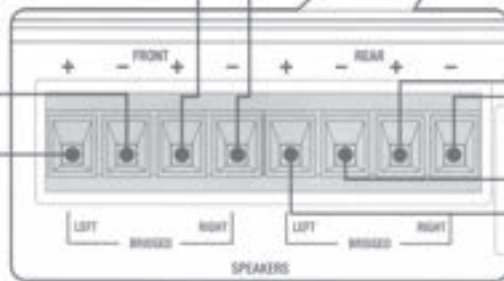
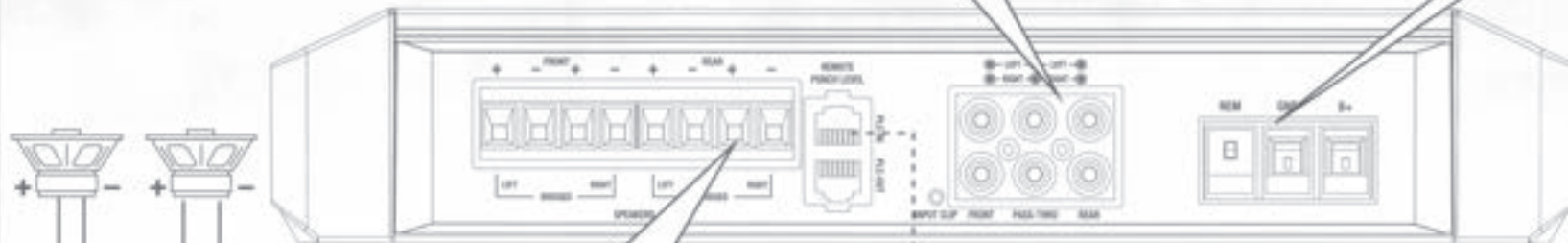

CAUTION
Be sure to connect speakers and Punch Level Control - PLC (if equipped) after amplifier output clip adjustment. (see reverse)

Optional Accessory PLC2



* Specifications subject to change without notice. Images depict typical setup. Refer to manual for additional wiring options.

Step 1 - Input

Input Clip Indicator Setup

Be sure to disconnect all speakers from the amplifier.

CAUTION

Failure to comply may cause damage to connected components and/or amplifier.



Step 2 - Input

Turn on the source unit with volume set to zero.



Step 3 - Input

Adjust the Bass & Treble levels on the source unit to flat.



Step 4 - Input

Insert test tone or music CD to play for setup.



Note: Use the 40Hz @ 0dB tone (Track 5) for mono amplifier applications or the 1kHz @ 0dB tone (Track 7) for multi-channel amplifier applications. Be sure your x-over is switched to the appropriate filter setting.

Step 5 - Input

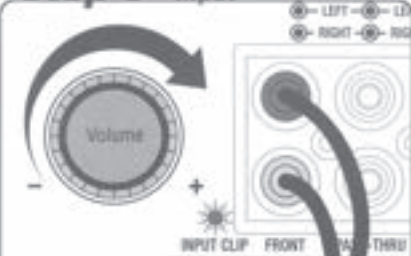

Increase the source unit volume until the Input Clip Indicator illuminates red.

Note: Input Clip can be viewed remotely with optional PLC2.

Step 6 - Input

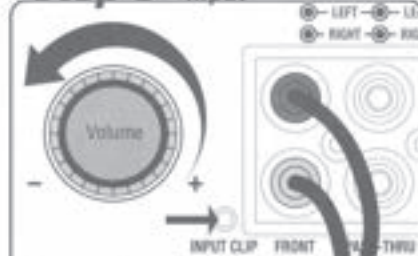

Decrease the source unit volume slightly until the light turns completely off. This establishes your maximum source unit volume for adjusting the Output Clip Indicator.

Note: Some source units will not clip.



Step 7 - Output

Be sure to disconnect Punch Level Control - PLC (if equipped) from the amplifier.

Step 8 - Output

Output Clip Indicator Setup



Adjust the Input Level knob until the Output Clip Indicator illuminates to the appropriate color. Repeat for all channel levels of input.

Step 9 - Output

Turn the source unit volume down.



Step 10 - Output

Reconnect all speakers and Punch Level Control - PLC (if equipped) to the amplifier. Be sure to maintain proper speaker polarity.

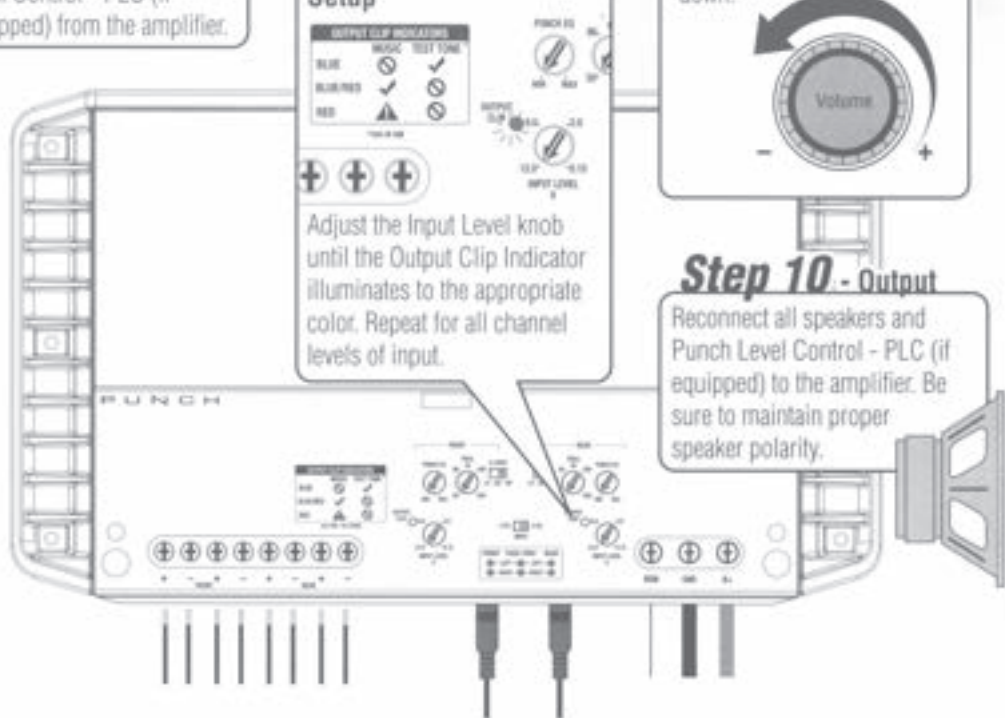

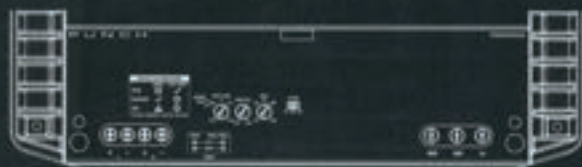
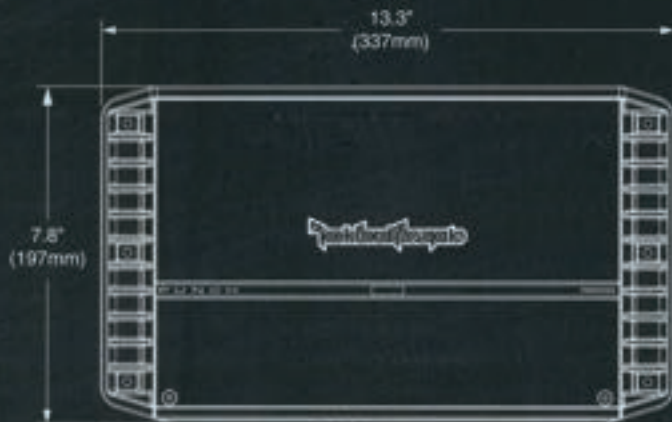
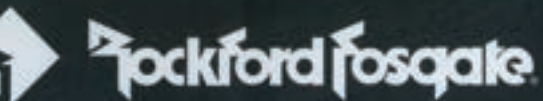

Stealth Top Mounted Control Panel



High Level Input Capable with Auto Turn On Circuit
(With Optional Accessory PP25W)



Input & Output Level Clip Indicators

ELEMENT READY

Rockford's Element Ready product line takes into account the effects of the environment and takes measures to ensure lasting performance.

UV Inhibitor Materials



Dust Resistant



Corrosion Protection
- Conformal Coated PCB Boards



Stainless Hardware

PM500X2

500 Watt Stereo Amplifier



- Rated Power: 150x2 @ 4 ohm, 250x2 @ 2 ohm, 500x1 @ 4 ohm/Bridged
- Crossover: 12dB/Oct Butterworth
- Crossover Frequency: Variable 50Hz-250Hz HP/AP/LP
- Punch EQ: 0-14dB @ 12.5kHz and 0-18dB @ 45Hz
- Power Terminals: 4 AWG

CLASS
ta



MEHSA





Rockford Fosgate

FREE!
1 YEAR
EXTENDED
WARRANTY
 with purchase of a qualifying
Rockford Fosgate
Amplifier
Installation Kit
 1175-56999-02

Rockford Fosgate
 Designed and Engineered in Tempe, AZ, U.S.A.
 Made In Thailand
PM500X2
 Manufacture Date: 2015-01-28

PM500X2

 7 80687 34511 2

Rockford Fosgate Tempe, AZ, United States
Made in Thailand



©2014 Rockford Corporation. All Rights Reserved. ROCKFORD FOSGATE, PUNCH® and associated logos where applicable are registered trademarks of Rockford Corporation in the United States and/or other countries. All other trademarks are the property of their respective owners. Specifications subject to change without notice.

1315-59344-01



SETUP DISC

AUDIO TRACKS

1. 3Sixty Level Set
2. 3Sixty OEM Integration
3. Left/Right/Center Channel ID
4. Polarity Pulses
5. 40Hz / 0dB
6. 400Hz / 0dB
7. 1kHz / 0dB
8. 4kHz / 0dB
9. 40Hz / -5dB
10. 400Hz / -5dB
11. 1kHz / -5dB
12. 4kHz / -5dB
13. 40Hz / -10dB
14. 400Hz / -10dB
15. 1kHz / -10dB
16. 4kHz / -10dB
17. 40Hz / -15dB
18. 400Hz / -15dB
19. 1kHz / -15dB
20. 4kHz / -15dB
21. Slow Sine Sweep 20Hz – 200Hz
22. Slow Sine Sweep 200Hz – 2kHz
23. Slow Sine Sweep 2kHz – 20kHz
24. Log Swept Chirp
25. Uncorrelated Pink Noise
26. Correlated Pink Noise
27. All Bits High

CD-ROM CONTAINS:

Product Manual(s)

1600-58530-01



Rockford Fosgate Tempe, AZ, United States

©2013 Rockford Corporation. All Rights Reserved. ROCKFORD FOSGATE, PUNCH and associated logos where applicable are registered trademarks of Rockford Corporation in the United States and/or other countries. All other trademarks are the property of their respective owners. Specifications subject to change without notice.

COMPACT
disc
DIGITAL DATA

SETUP DISC

1. 3Sixty Level Set
2. 3Sixty OEM Integration
3. Left/Right/Center Channel ID
4. Polarity Pulses
5. 40Hz / 0dB
6. 400Hz / 0dB
7. 1kHz / 0dB
8. 4kHz / 0dB
9. 40Hz / -5dB
10. 400Hz / -5dB
11. 1kHz / -5dB
12. 4kHz / -5dB
13. 40Hz / -10dB
14. 400Hz / -10dB

15. 1kHz / -10dB
16. 4kHz / -10dB
17. 40Hz / -15dB
18. 400Hz / -15dB
19. 1kHz / -15dB
20. 4kHz / -15dB
21. Slow Sine Sweep 20Hz-200Hz
22. Slow Sine Sweep 200Hz-2kHz
23. Slow Sine Sweep 2kHz-20kHz
24. Log Swept Chirp
25. Uncorrelated Pink Noise
26. Correlated Pink Noise
27. All Bits High

CD-ROM

Product Manual(s)

rockfordfosgate.com • 600 S. Rockford Drive • Tempe, AZ 85281 • 1-800-669-9899



Rockford Fosgate

COMPACT
disc
DIGITAL DATA

©2013 Rockford Corporation. All Rights Reserved. All trademarks are the property of their respective owners.

CERTIFICATE OF PERFORMANCE VERIFICATION

Model #: **PM500X2** Serial #: XXXXXXXXXX Birth Date: **01/28/2015** Test System: **RF-RATS-1**

SYSTEM OPERATION	Idle Current Measure Current Draw at Idle A PASS	System Voltage Check System Reference Voltages V1 3.851 V2 4.937
	Bias Set Output Channel Bias CH1 PASS CH2 PASS CH3 N/A CH4 N/A	High Rail Voltage Check Amplifier Rail Voltages V1 46.03 V2 -46.00 V3 N/A
	DC Offset Check for No DC Voltage on Outputs CH1 .004 CH2 .012 CH3 N/A CH4 N/A CH5 N/A	Low Rail Voltage Check Amplifier Rail Voltages V1 16.37 V2 -16.29
	Dark Current Current Draw < 100uA A PASS	Gain Tracking Check Gain Tracking Between Channels (dB) CH1 0.045 CH2 0.045 CH3 N/A CH4 N/A

SIGNAL	Frequency Response 20Hz-20kHz Sweep @ 1W RMS CH1 PASS CH2 PASS CH3 N/A CH4 N/A CH5 N/A	High Pass Crossover Check 20Hz-20kHz Sweep @ 1W RMS CH1 PASS CH2 PASS CH3 N/A CH4 N/A CH5 N/A
	Remote Level & 2/4/5 Ch. Select Check 20Hz-20kHz Sweep @ 1W RMS CH1 PASS CH2 PASS CH3 N/A CH4 N/A CH5 N/A	Low Pass Crossover & Punch EQ Check 20Hz-20kHz Sweep @ 1W RMS CH1 PASS CH2 PASS CH3 N/A CH4 N/A CH5 N/A
	Common Mode Rejection Rated 20Hz-20kHz Sweep @ 1W RMS CH1 PASS CH2 PASS CH3 N/A CH4 N/A CH5 N/A	Channel Separation from Left to Right 20Hz-20kHz Sweep @ Rated RMS Power CH1 PASS CH2 PASS CH3 N/A CH4 N/A CH5 N/A
	Signal to Noise Ratio 20Hz-20kHz Sweep @ Rated RMS Power CH1 PASS CH2 PASS CH3 N/A CH4 N/A CH5 N/A	Total Harmonic Distortion 20Hz-20kHz Sweep @ 1W RMS (%) CH1 0.104 CH2 0.118 CH3 N/A CH4 N/A CH5 N/A
	Input Sensitivity Check Sensitivity @ Minimum CH1 PASS CH2 PASS CH3 N/A CH4 N/A CH5 N/A	Total Harmonic Distortion Rated (%) 20Hz-20kHz Sweep @ Rated RMS Power CH1 0.015 CH2 0.015 CH3 N/A CH4 N/A CH5 N/A

RELIABILITY	Short Protect Short All Channels Sequentially @ 1% THD CH1 PASS CH2 PASS CH3 N/A CH4 N/A CH5 N/A	Thermal Test Thermistor Voltage Check TH1 0.624 TH2 1.697 TH3 1.788 TH4 N/A TH5 N/A
	Burn-In Amplifier Accelerated Life Monitor (45 sec. @ 1% THD) CH PASS TH PASS V PASS BIAS PASS IR PASS	

POWER	Channel Power Individual Channel Power @ 1% THD @2 Ω CH1 341 CH2 341 CH3 N/A CH4 N/A CH5 N/A	Total Power Total RMS Power @ 1% THD <div style="text-align: center; font-size: 2em; font-weight: bold;">683 watts</div>
	Total Power Total RMS Power @ Each Impedance @ 1% THD 4Ω 419 2Ω 683 1Ω N/A 21Ω N/A	

ALL Rockford Fosgate amplifiers are designed, developed, manufactured and tested in accordance with the CEA-2006 amplifier rating requirements. All tests conducted at 14.4Vdc. Min Impedance, 1kHz(ab/ad) or 100Hz (bd) unless otherwise stated.
 ©2012 Rockford Corporation. All Rights Reserved. ROCKFORD FOSGATE, and associated logos where applicable are registered trademarks of Rockford Corporation in the United States and/or other countries. All other trademarks are the property of their respective owners. Specifications subject to change without notice.





Are You Engineered to Rock?

Get a One-Year Extended Warranty when you use a matching Rockford Fosgate Amplifier Installation kit with your Amplifier!

We want you to get the performance and reliability that made Rockford Fosgate Amplifiers famous. Using poor-quality under-spec wiring is a guaranteed way to get less than you paid for from your system.

We are so certain that getting your system wired to rock with the right wire and cables will make a difference, that we will give you an additional 1 year warranty on your amp when you use the matching amplifier installation kit. See your dealer to determine the matching kit for your amplifier.

To extend your warranty under this program attach the serial number sticker or UPC code removed from the original amplifier installation kit package in the box below. Keep this form along with your original purchase receipt.

One warranty extension per amplifier regardless of the number of amplifier kits purchased. Amplifier and wiring kit must be purchased at the same time.

What is Covered

This warranty applies only to Rockford Fosgate products sold to consumers by Authorized Rockford Fosgate Dealers in the United States of America or its possessions. Product purchased by consumers from an Authorized Rockford Fosgate Dealer in another country are covered only by that country's Distributor and not by Rockford Corporation.

Who is Covered

This warranty covers only the original purchaser of Rockford product purchased from an Authorized Rockford Fosgate Dealer in the United States. In order to receive service, the purchaser must provide Rockford with a copy of the receipt stating the customer name, dealer name, product purchased and date of purchase. Products found to be defective during the warranty period will be repaired or replaced (with a product deemed to be equivalent) at Rockford's discretion.

What is Not Covered

1. Damage caused by accident, abuse, improper operations, water, theft, shipping
2. Any cost or expense related to the removal or reinstallation of product
3. Service performed by anyone other than Rockford or an Authorized Rockford Fosgate Service Center
4. Any product which has had the serial number defaced, altered, or removed
5. Subsequent damage to other components
6. Any product purchased outside the U.S.
7. Any product not purchased from an Authorized Rockford Fosgate Dealer

Limit on Implied Warranties

Any implied warranties including warranties of fitness for use and merchantability are limited in duration to the period of the express warranty set forth above. Some states do not allow limitations on the length of an implied warranty, so this limitation may not apply. No person is authorized to assume for Rockford Fosgate any other liability in connection with the sale of the product.

How to Obtain Service Under the Extended Warranty Program

The amplifier must be returned by the customer (you) or an authorized Rockford Fosgate retailer with a copy of the original receipt and the ORIGINAL Performance Verification Certificate with the serial number or UPC code from the amp installation kit. Contact your Authorized Rockford Fosgate Dealer or our Customer Support Specialists (1-800-669-9899) for assistance.

EU Warranty

This product meets the current EU warranty requirements, see your Authorized dealer for details.
"This Additional One-Year Warranty" is only available where allowed under local laws.

Attach Amplifier Installation Kit
Serial Number or UPC Code from
original packaging here.