

Purpose

The GMPD3 lets you connect and control an Apple iPod directly from the controls on your factory GM radio. All factory options, including XM, continue to operate!

Features

The GMPD3 uses a simple “Y” or “T” harness for installation using factory connectors. There is *no need* to cut or splice any wires, including power and ground!



The GMPD3 works in the following vehicles:

|                   |           |                        |           |
|-------------------|-----------|------------------------|-----------|
| <b>BUICK</b>      |           | <b>GMC</b>             |           |
| Lucerne*          | 2006–2008 | Sierra/Denali/HD Truck | 2007–2008 |
|                   |           | Yukon/Denali/XL        | 2007–2008 |
| <b>CADILLAC</b>   |           | <b>HUMMER</b>          |           |
| Escalade/EXT/ESV* | 2007–2008 | H2/HUT                 | 2008      |
| <b>CHEVROLET</b>  |           | <b>PONTIAC</b>         |           |
| Avalanche*        | 2007–2008 | Torrent*               | 2007–2008 |
| Cobalt*           | 2007–2008 |                        |           |
| Equinox*          | 2007–2008 |                        |           |
| Impala*           | 2006–2008 |                        |           |
| Monte Carlo*      | 2006–2008 |                        |           |
| Pickup HD*        | 2007–2008 |                        |           |
| Suburban*         | 2007–2008 |                        |           |
| Tahoe*            | 2007–2008 |                        |           |
|                   |           | <b>SUZUKI</b>          |           |
|                   |           | XL7*                   | 2007      |

Check [www.soundgate.com](http://www.soundgate.com) for the most current compatibility information.

Simple-fi.™

Copyright© 2004-2007 SoundGate®. All Rights Reserved.  
SoundGate® is a registered trademark of Stillwater Designs, Inc.  
All other trademarks are the property of their respective owners.

[www.soundgate.com](http://www.soundgate.com)

Rev 20080624

If you experience problems, call SoundGate Technical Support at 800-256-0808, or email us at [sgtech@soundgate.com](mailto:sgtech@soundgate.com).

Before You Start

WARNING

**DO NOT DISASSEMBLE OR ALTER**  
Doing so may result in an accident, fire, or electric shock.

**Do not block your view**  
Do not mount product or any added audio/video equipment where it can block your view through the windshield or block your view of dashboard indicators and displays.

**Do not block safety devices**  
Do not mount product or any added audio/video equipment where it can obstruct the operation of any safety device, such as the airbag.

**Distraction warning**  
Do not allow product or any added audio/video equipment to distract you while you are driving.

**BEFORE WIRING, DISCONNECT THE CABLE FROM THE NEGATIVE BATTERY TERMINAL**  
Before starting any installation work, wait 90 seconds after turning the ignition switch to the LOCK position and disconnecting the negative (-) terminal from the battery. The supplemental restraint system (SRS), or airbag(s) is equipped with a backup power source. If installation work is started less than 90 seconds after disconnection of the negative (-) battery terminal, the SRS may deploy. When the negative (-) terminal cable is disconnected from the battery, the clock and audio systems' memory may be erased. Before starting installation work, make a record of the clock and audio systems' memory settings. When installation is complete, reset the clock and audio systems to their previous settings. Power tilt, power telescopic steering column, power seats, power mirrors, power shoulder belt anchorage, and other power accessories may or may not be equipped with a memory function; consider keeping a record of these settings as well.

When installation is complete, readjust the features to their previous settings.  
Never use a backup power supply (such as another battery) during installation work in an attempt to avoid losing these memory settings.

Before You Start

CAUTION

**DO NOT SPLICE INTO ELECTRICAL CABLES**  
Never cut away cable insulation to supply power to other equipment. Doing so will exceed the current carrying capacity of the wire and may result in fire or electric shock.

**DO NOT ALLOW CABLES TO BECOME ENTANGLED IN SURROUNDING OBJECTS**  
Cables or wiring that obstruct or get caught on places such as the steering wheel, shift lever, brake pedals, etc. can be extremely hazardous.

**DO NOT INSTALL IN LOCATIONS WITH HIGH MOISTURE OR DUST**  
Moisture or dust may result in product failure.

**HAVE THE WIRING AND INSTALLATION DONE BY EXPERTS**  
The wiring and installation of this product requires special technical skills and experience.

**USE ONLY SPECIFIED ACCESSORY PARTS**  
Use of other than specified parts may damage product internally.

**FOLLOW THE OPERATIONAL AND INSTALLATION MANUALS.**  
YOU SHOULD READ AND FAMILIARIZE YOURSELF THOROUGHLY WITH THE FOLLOWING INFORMATION PRIOR TO INSTALLING AND USING THIS UNIT. IN ADDITION, YOU MUST CAREFULLY READ AND FOLLOW THE INSTALLATION SCHEMATICS AND INSTRUCTIONS FOR THE PRODUCT AND THE VEHICLE IN WHICH IT IS BEING INSTALLED. FAILURE TO FOLLOW INSTALLATION INSTRUCTIONS MAY DAMAGE THE PRODUCT AND THE VEHICLE, WILL VOID THE PRODUCT WARRANTY, AND MAY VOID THE VEHICLE WARRANTY.

**CHECK YOUR LOCAL LAWS**  
Some States/Provinces or other governmental jurisdictions (such as cities) may have laws that prohibit the operation of a video screen within the sight of the driver. If you have purchased such a product, you should use the product only in locations where it is legal to do so, and if you do use the product, set up the screen so it is only visible to passengers.

**TROUBLESHOOTING**  
Should this product fail to operate properly, please contact your Dealer or SoundGate Technical Support.

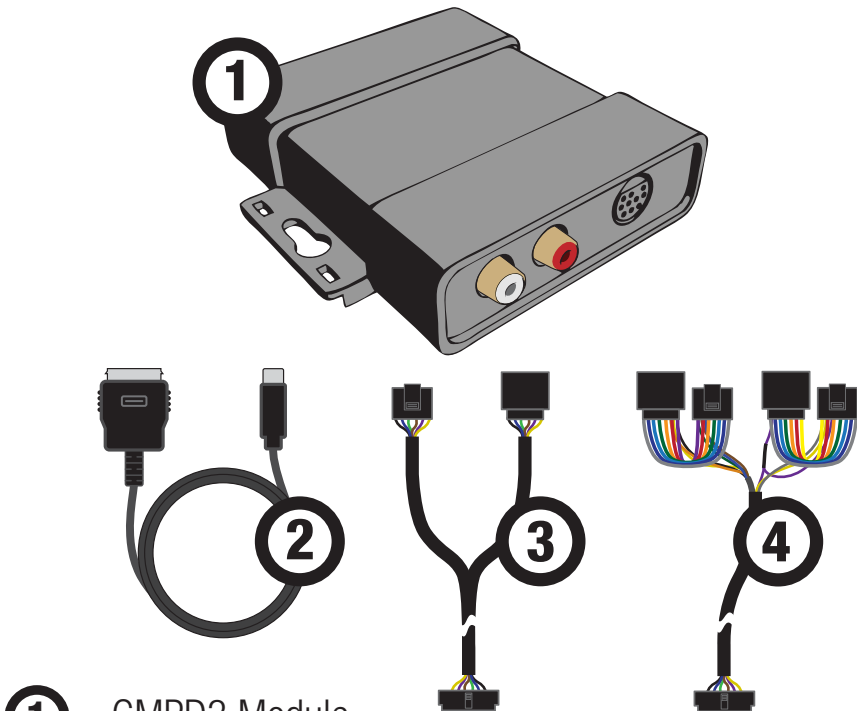

- ① – GMPD3 Module
- ② – Apple iPod dock connector
- ③ – “Y” harness (for radios *with* factory XM)
- ④ – “T” harness (for radios *without* factory XM)

Note: More than one “T” harness is included. Please read the *INSTALLATION* section for details on which harness you should use for your vehicle.

Before You Start

**iPOD Details**  
The GMPD3 is designed to interface only with the GM vehicles listed on the front of this manual and the Apple iPod (4th generation and later), iPod Mini, iPod Nano, iPod Photo, and iPod Video.

We recommend that you turn on your iPod's *SoundCheck* option. On certain factory radios, you may experience audible distortion if *SoundCheck* is not turned on.

**Installation Overview**  
Please read this section fully and follow these steps closely to ensure that the GMPD3 functions correctly upon installation. The basic install procedure is outlined below (detailed steps are presented in the *INSTALLATION* section of this manual).

1. Configure DIP switches on GMPD3 module.
2. Connect “T” harness to factory radio (or “Y” harness to factory XM module).
3. Connect “T” (or “Y”) harness to GMPD3 module.
4. Connect iPod dock connector cable (and optionally connect an AUX input source) to GMPD3 module.
5. Mount the GMPD3 module.
6. Connect iPod to GMPD3 iPod dock connector cable.

**Configuration**  
The GMPD3 must be configured before installation and use. On the rear side of the GMPD3 module is a series of five small, DIP-style switches that must be set to a specific combination of **ON** and **OFF**, depending upon whether or not your vehicle has a factory-equipped XM tuner. Use the diagrams below to configure the DIP settings for your vehicle.





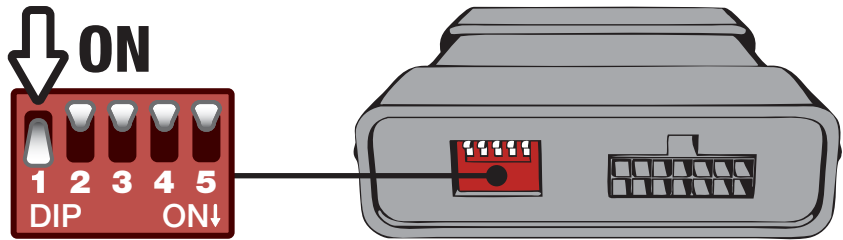

IMPORTANT

During configuration of the DIP switches, no cables should be connected to the GMPD3 module. If you change DIP switch settings while cables are connected, you must unplug the cables and reconnect them before the changes will take effect. This is especially important to remember if transferring the GMPD3 from one vehicle to another, as re-programming the DIP switches may be necessary.

Five DIP switches are located on the rear of the GMPD3. To configure a switch to the **ON** position, press the switch **downward**. Press the switch **upward** for the **OFF** position. In this example, switch 1 is turned **ON**.



**DIP settings for the GMPD3 iPod interface:**  
For compatible GM vehicles (listed on the front of this manual) equipped with **GMLAN 29-bit radios**....

|   |   |  |
|---|---|--|
| <p>Standard Radio<br/><b>WITH</b> Factory XM</p>  <p>1: <b>ON</b><br/>2: <b>ON</b><br/>3: OFF<br/>4: OFF<br/>5: OFF</p> <p><b>WITHOUT</b> Factory XM</p>  <p>1: OFF<br/>2: <b>ON</b><br/>3: OFF<br/>4: OFF<br/>5: OFF</p> | <p>Navigation Radio<br/><b>WITH</b> Factory XM</p>  <p>1: <b>ON</b><br/>2: OFF<br/>3: OFF<br/>4: OFF<br/>5: OFF</p> <p><b>WITHOUT</b> Factory XM</p>  <p>1: OFF<br/>2: <b>ON</b><br/>3: OFF<br/>4: OFF<br/>5: OFF</p> | <p>Escalade Radio (non-Navigation)<br/><b>WITH</b> Factory XM</p>  <p>1: <b>ON</b><br/>2: <b>ON</b><br/>3: <b>ON</b><br/>4: OFF<br/>5: OFF</p> <p><b>WITHOUT</b> Factory XM</p>  <p>1: OFF<br/>2: <b>ON</b><br/>3: <b>ON</b><br/>4: OFF<br/>5: OFF</p> |
|---|---|--|

## Installation

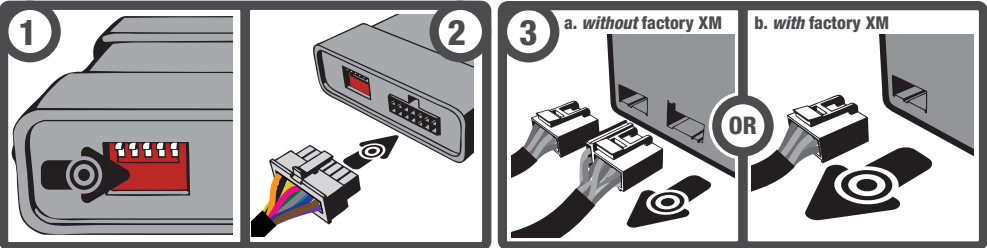

|  |   |  |  |
|--|---|--|--|
| Configure DIP switches (see previous section). | Connect appropriate "T" or "Y" harness to GMPD3 module (see below for details on which harness you should use). | Disconnect double multi-pin factory connectors from your factory radio (see page below for details). | Disconnect 16-pin factory connector from your factory XM module. |
|--|---|--|--|

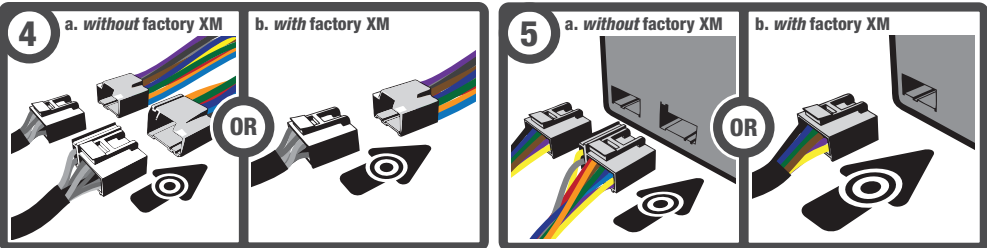

|   |   |   |   |
|---|---|---|---|
| Connect double multi-pin factory connectors to matching locations on the GMPD3 "T" harness. | Connect 16-pin factory connector to matching location on the GMPD3 "Y" harness. | Connect GMPD3 "T" harness to factory radio. | Connect GMPD3 "Y" harness to factory XM module. |
|---|---|---|---|

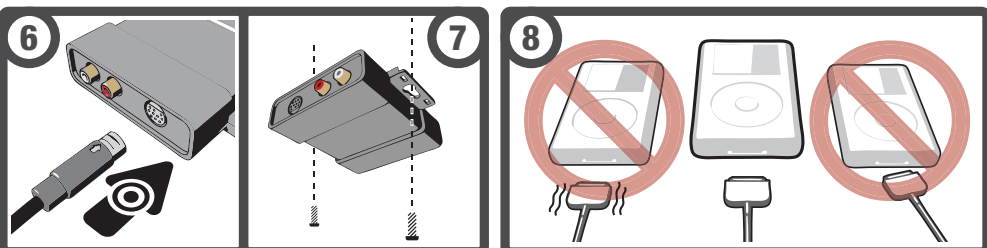

Connect iPod Dock cable to the GMPD3. You may optionally connect an AUX input source as well.

Mount the GMPD3 (behind dash or glove compartment). Be careful not to drill into wiring or vehicle mechanisms.

Connect iPod to GMPD3 iPod dock connector. Plug the connector in straight. Do not insert the cable at an angle or wiggle the cable during insertion.

## Detailed Installation Guide

**STEP 1** Turn your vehicle off and disconnect the negative terminal of your battery. Configure the DIP switches on the rear of the GMPD3 module (see page 3 for details).

**STEP 2** If your vehicle is not equipped with a factory XM tuner, connect the included “T” harness to the GMPD3 module and use the following steps suffixed with a. If your vehicle is equipped with a factory XM tuner, connect the included “Y” harness to the GMPD3 module and use the following steps suffixed with b.

**STEP 3a** If your vehicle **is not** equipped with a factory XM tuner, the GMPD3 will interface directly to the back of your factory radio. Consult factory literature or professional help for detailed radio access information. Generally, the trim panel around the outside of the radio will pull free on late model radios, exposing the bolts holding the radio in place. Remove the bolts (7mm) to view the desired connections (other radios may require extra panels to be removed before the back of the radio can be viewed). The radio may contain several connectors, but only two will match the connectors on one of the included GMPD3 "T" harnesses. Locate the matching connectors and disconnect them from the factory radio. These connectors are typically 14-pin and 16-pin; however, depending upon the vehicle, the number of pins may differ. Ensure that you only disconnect the connectors that match the GMPD3 "T" harness.

**STEP 3b** If your vehicle **is** equipped with a factory XM tuner, the GMPD3 will interface directly with your factory XM module. Locate the XM module in your vehicle or consult with a professional for help. Typically, the XM module is located behind the glove compartment in SUVs or in the back deck in cars and “crossover” vehicles. The XM module has a single 16-pin connector and an antenna connected. Disconnect the 16-pin connector from the factory XM module.

**STEP 4a** Connect the factory 14-pin and 16-pin connectors that you disconnected from the radio in step **3a** to the matching locations on the GMPD3 "T" harness.

**STEP 4b** Connect the factory 16-pin connector that you disconnected from the XM module in step **3b** to the matching location on the GMPD3 “Y” harness.

**STEP 5a** Connect the remaining 14-pin and 16-pin connectors on the GMPD3 "T" harness to the matching locations on the back of the factory radio.

# Installation

**STEP 5b** Connect the remaining 16-pin connector on the GMPD3 “Y” harness to the matching location on the factory XM module.

**STEP 6** Connect the iPod dock connector cable to the GMPD3 module. You may also connect an optional AUX input to the RCA connectors on the GMPD3 module (white = LEFT, red = RIGHT).

**STEP 7** Mount the GMPD3 module either behind the dash or glove compartment (mounting hardware not included). Be careful not to drill into wiring or vehicle mechanisms. You are solely responsible for securely fastening the GMPD3 in your vehicle. Ensure that the iPod dock connector is left in a convenient place for connection to your iPod/iPhone.

**STEP 8** Connect your iPod to the GMPD3 dock connector. Plug the connector in straight. Do not insert the cable at an angle or wiggle the cable during insertion.

## Operation



## Operation Instructions

The following instructions will demonstrate how to navigate through your iPod music and playlists using the controls on your factory radio. The factory radio controls and their corresponding functions are illustrated here; however, please note that these examples only represent the most common GMLAN 29-bit radio interfaces—your radio's controls may differ slightly.

Please use the following section as a general operational guide for the GMPD3 interface and the following GMLAN 29-bit radios.



## GMLAN 29-bit Standard Radio

Use the following diagrams as a general visual reference to differentiate between GMLAN 11-bit radios of **type “1”** and **type “2”**. Please note that your radio’s controls may differ slightly.

- Press and hold **◀SEEK** while in XM mode to switch between factory XM and iPod/AUX input.
- Use the pushbuttons below the **IPOD** and **AUX** labels on the display to switch between iPod and AUX input.
- Press the **CAT** button to show folders on the display for iPod playlists, Artist, Album, Genre, Song, and AUX input. Use the **TUNE** [  ] knob to navigate through folders.
- Select a displayed item with **SEEK▶**.
- During playback, use the **◀SEEK** buttons to move forward or back through the current iPod folder.
- Press and hold the **◀SEEK** buttons to FF or RW. Press the buttons again to stop FF/RW.
- During playback, turn the **TUNE** [  ] knob to advance through songs by increments of 10.
- Press the **INFO** [  ] button to display Song number, Name, Artist, and Album.

## GMLAN 29-bit Navigation Radio

*standard screen view*

- Press and hold **◀SEEK** while in XM mode to switch between factory XM and iPod/AUX input.
- Press the **Center Folder** (iPod songs, albums, artists, etc.) on the touchscreen to advance to the search-screen view.
- Use the **TUNE** [  ] knob to navigate through folders selected via the search-screen view.
- Press **SEEK▶** to select a displayed item for playback.
- During playback, use the **◀SEEK▶** buttons to move forward or back through the current iPod folder.
- Press and hold the **◀SEEK** buttons to FF or RW. Press the buttons again to stop FF/RW.
- During playback, turn the **TUNE** [  ] knob to advance through songs by increments of 10.



*search-screen view*

- Select **MUSIC** to view iPod search options. Your iPod can be navigated by Playlist, Artist, Album, Genre, or All Songs simply by selecting one of these categories, then pressing the **BACK** button. *Note: after pressing the **BACK** button on the touch-screen, you will return to the standard screen view.*
- Select **SOURCE** to view audio source options. Select **IPOD** for iPod audio. Select **AUX** to switch to AUX input. Select **RADIO** to return to standard AM/FM/XM. *Note: changes do not take effect until you press the **BACK** button on the touch-screen.*
- Select **SWREV** to view the current GMPD3 software revision.

## Operation

## GMLAN 29-bit Cadillac Escalade Navagation Radio

Use the Navigation Radio instructions from above with the following exceptions:

- **SEEK** buttons are oriented vertically (▼SEEK▲).
- During playback, turn the **TUNE** [  ] knob or press the ▼SEEK▲ buttons to advance through songs one at a time.
- In standard screen view, the side scroll buttons on the touchscreen are inactive; use the **TUNE** [  ] knob or the ▼SEEK▲ buttons instead.

***Why SoundGate Dealers  
have the edge...***

The technologies used in today's vehicles are as sophisticated as any laptop computer. At SoundGate we believe these new technologies are full of opportunities for mobile electronic dealers across the nation. We make it a high priority to not only research these new systems, but to understand them and their impact on the aftermarket car audio industry. Armed with this knowledge, we are well equipped to help you integrate new components into these systems with our innovative, high-performance interfaces and unparalleled technical support.

***Be sure to ask your  
autosound specialist  
about these other exciting  
SoundGate products...***

- Auxiliary Input Interfaces and Docking Stations which allow you to input audio from MP3 Players, DVD/Video, Satellite Radio, and more to OEM and aftermarket car audio systems
- High-performance Radio Replacement
- Interfaces for seamlessly integrating new receivers or CD players into OEM audio systems
- Competition-Grade Interfaces for adding amplifiers
- Remote Audio Control Interfaces that let you control aftermarket receivers and CD players from your factory rear seat, or steering-wheel mounted audio controls.
- And many others!

# Simple-fi.™

**www.soundgate.com**

iPod is a trademark of Apple Computer, Inc., registered in the U.S. and other countries.

Copyright© 2004-2007 SoundGate®. All Rights Reserved. SoundGate® is a registered trademark of Stillwater Designs, Inc. All other trademarks are the property of their respective owners.